



Charta Road, Egham, Surrey, TW20 8XG

£440,000 F/H



Set in a quiet no through road is this three bedroom end of terrace house with the huge benefit of a garage with parking to front, as well as a first floor bathroom and ground floor cloakroom. Located close to schools and shops with Egham High Street and station only a fifteen minute walk. Being sold with no onward chain.

Charta Road, Egham, Surrey, TW20 8XG

FLOOR PLAN

Ground Floor

Approx. 37.5 sq. metres (404.2 sq. feet)

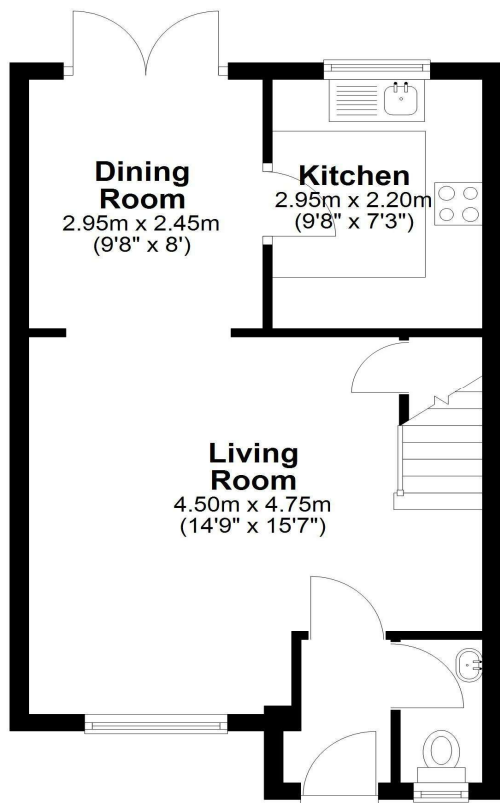

First Floor

Approx. 35.8 sq. metres (385.8 sq. feet)

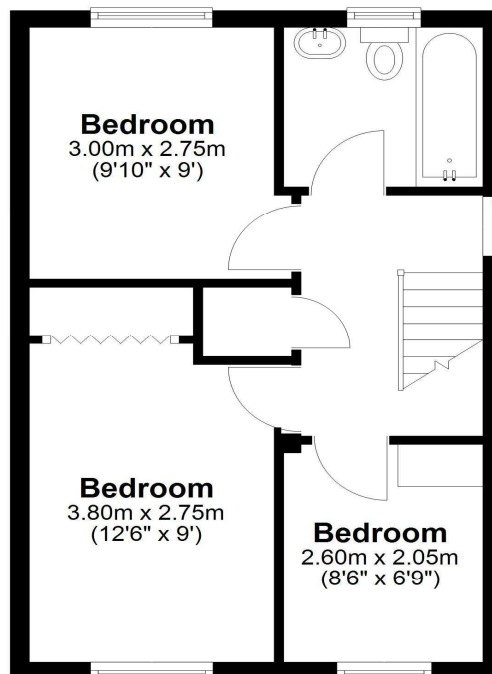

Total area: approx. 73.4 sq. metres (789.9 sq. feet)

EPC

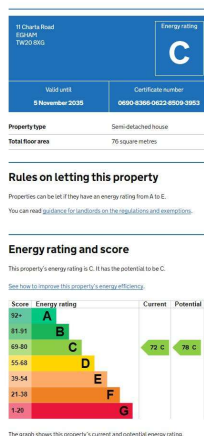

COUNCIL TAX BAND:

D - Runnymede Borough Council

VIEWINGS:

**By appointment with the clients selling agents,
Nevin & Wells Residential on 01784 437 437 or
visit www.nevinandwells.co.uk**



All measurements are approximate. Nevin & Wells Residential have not tested any systems or appliances.