



**Nairn Court, Kilwinning**

**Offers Over £119,995**







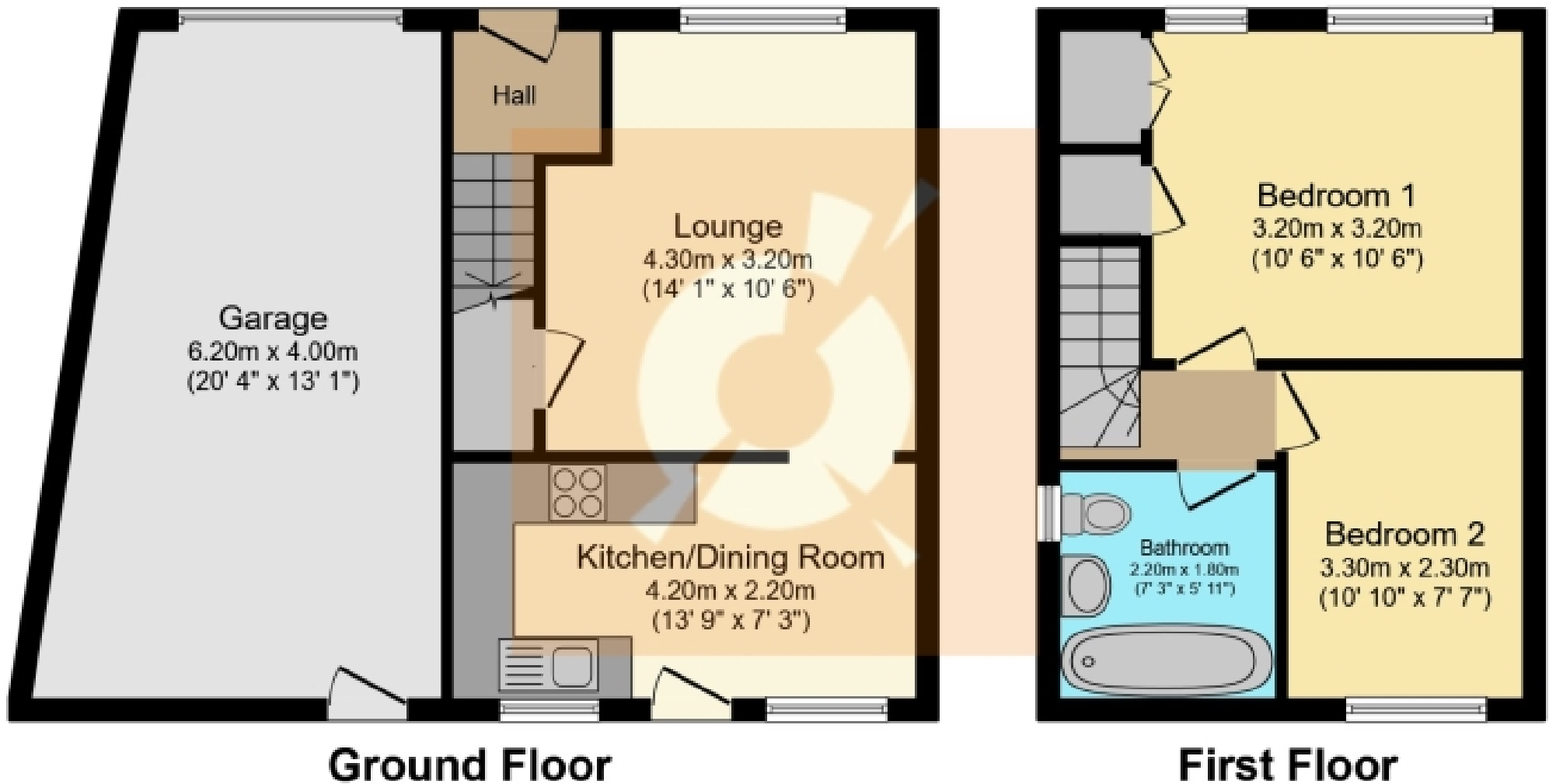

This plan is for illustration purposes only and may not be representative of the property. Plan not to scale.

## THE PROPERTY

### What Our Clients Love About Nairn Court:

“I have spent 16 happy years in 6 Nairn Court. I fell in love with the house as soon as I walked through the door. The street has the best neighbours who look out for each other, and I have made friends for life. It will be bittersweet to leave but I'm moving onto a new chapter. I hope whoever buys this amazing, cosy home will make as many happy memories here as I have.”

Welcome to No. 6 Nairn Court. This fantastic semi-detached property is well located within the ever-popular Whitehurst area of Kilwinning, it offers spacious accommodation and is sure to appeal to a wide range of purchasers including first-time buyers, growing families, and professionals alike. To the front, the property has a low maintenance chipped garden. There is a monobloc driveway leading to a garage with electrics, offering desirable off-street parking solutions. The lounge is spacious in size and has been decorated with a soft and inviting décor palette throughout, with neutral toned carpets and wall coverings. A large, double glazed window unit provides a lovely stream of natural light and a focal point fireplace with decorative surrounds provides a cosy warmth – ideal for the whole family to relax and unwind in front of after a long day.

The archway provides an open-plan layout flowing through to the dining kitchen. The kitchen is modern in style white always on-trend white wall and base units, white tiled surrounds, spotlight light fixtures, butcherblock worktops and complimentary toned, wood effect flooring.

A carpeted stairway leads to the upper level where two generously proportioned, double bedrooms are housed with Bedroom One benefitting from convenient in-built storage solutions. Completing the internal accommodation is the pristine, three-piece bathroom. This has been decorated with soothing beige tones and is comprising of w.c, hand wash basin and bath with glass shower screen and shower overhead.

To the rear, the property has a well and easily maintained garden. This has been laid in a mix of decorative chips and planting and also features a sociable decking area – ideal for relaxing or entertaining during the summertime. The garden further benefits from an outside tap and two outdoor sockets.

The property is located within the Whitehurst Park area of Kilwinning, an ever-popular residential suburb. Kilwinning itself has a great host of local amenities ranging including eateries, health centres, shops, transport links and schooling. Please check The Property Boom website for detailed information on local schooling. The West Coast with beautiful sandy beaches is only 10 minutes' drive or a short train journey away.

This property is sure to be very popular therefore we would highly recommend an early viewing. Viewing by appointment - please contact The Property Boom to arrange a viewing or for any further information and a copy of the Home Report. Any areas, measurements or distances quoted are approximate and floor Plans are only for illustration purposes and are not to scale. Thank you. THESE PARTICULARS ARE ISSUED IN GOOD FAITH BUT DO NOT CONSTITUTE REPRESENTATIONS OF FACT OR FORM PART OF ANY OFFER OR CONTRACT.

[www.thepropertyboom.com](http://www.thepropertyboom.com)  
70 West Regent Street, Glasgow, G2 2QZ  
Tel: 0333 900 9089 / Email: [smile@thepropertyboom.com](mailto:smile@thepropertyboom.com)