



Pooley Green Road, Egham, TW20 8AL

OIEO £425,000 Freehold



Unexpectedly re-available is this detached bungalow. Offering tonnes of potential to build up and out (subject to planning permission). There are two double bedrooms, two receptions, conservatory, large garden, off street parking for several vehicles and side access. Viewings by appointment only and proof of funds or a copy of a mortgage agreement in principle must be shown before viewing. **Zero stamp duty for FIRST TIME BUYERS up to £425,000.**

Pooley Green Road Egham, Surrey, TW20 8AL

FLOOR PLAN

Ground Floor

Approx. 83.2 sq. metres (895.3 sq. feet)

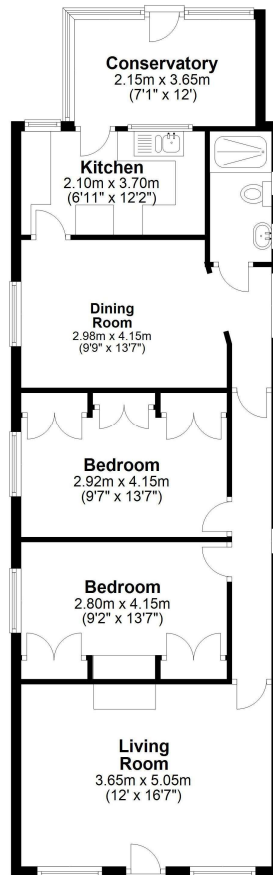

All measurements are approximate. Nevin & Wells Residential have not tested any systems or appliances.

EPC

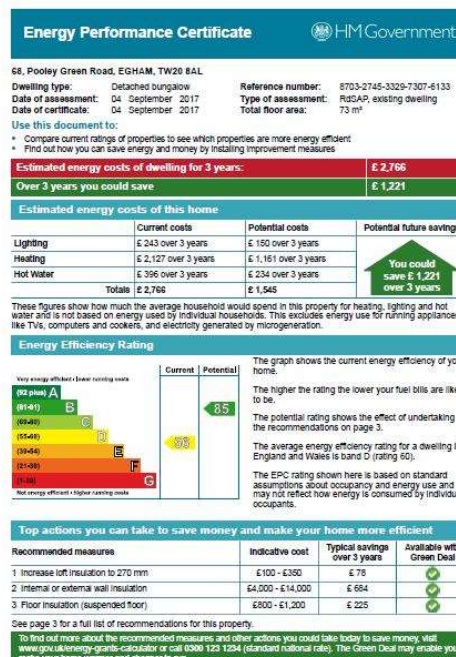

COUNCIL TAX BAND: D - Runnymede Borough Council