



£1,325 pcm

3 Bedroom Semi-Detached House to rent
3 Hare Crescent, Hethersett, Norwich





Overview

This modern 3-bedroom rental home is available immediately for long-term occupancy. In good condition and providing plenty of natural light throughout, it's also pet-friendly, making it your perfect move in 2025. Click here to not miss out on this great opportunity!



Key Features

- Available Now - Long-Term Rental Opportunity
- Modern 3-Bedroom House
- Good Condition and Unfurnished
- Fully-Integrated Kitchen and Ample Storage Throughout
- Pets Friendly
- Two Side-by-Side Driveway Spaces
- Enclosed Low-Maintenance Garden with Shed
- Short Drive to the NNUH, UEA and Norwich City Centre





Welcome to Hare Crescent, Hethersett. This property offers a convenient and functional layout, perfect for comfortable living. The property features a spacious kitchen-diner that seamlessly flows into a large lounge. The ground floor comes complete with an entrance space and a cloakroom. Three bedrooms are serviced by an ensuite shower room and a separate bathroom with electric shower, alongside ample storage.

Step outside to find an enclosed, low-maintenance garden complete with decking, an outside tap, and a handy storage shed. The property also offers driveway parking for two vehicles side-by-side, along with open-reach views to the front, enhancing the sense of space and tranquility.

Convenience is key with this home, as it's just a short drive or bicycle ride away from local amenities, the Norfolk and Norwich University Hospital (NNUH), and the University of East Anglia (UEA). With the A11 and A47 only minutes away, commuting is a breeze. Additionally, dog-walking and running paths are right on your doorstep, as well as multiple play parks for enjoying the fresh air.

We are open 24/7 to receive your request and look forward to welcoming you.

What3Words: ///claps.foal.reporters



Kitchen Diner

15' 8" x 8' 10" (4.80m x 2.70m)

Tiled flooring, uPVC double-glazed window and French doors, fitted base and wall-mounted units, houses the combi boiler, integrated fridge-freezer, oven, washing machine, dishwasher and extractor hood, ceiling light, multiple sockets and radiator.

Living Room

14' 3" x 12' 1" (4.35m x 3.70m)

Fitted carpet, uPVC double-glazed window, storage cupboard, ceiling light, multiple sockets, broadband connection and radiator.

WC

Luxury vinyl flooring, uPVC double-glazed obscured window, toilet, Vanity wash hand basin, tiled walls, radiator and ceiling light.

Bedroom 1

12' 1" x 10' 0" (3.70m x 3.05m)

Fitted carpet, uPVC double-glazed window, triple wardrobe with mirrored sliding doors, storage cupboard over stairs, thermostat, ceiling light, multiple sockets and radiator.

Ensuite Shower Room

Luxury vinyl flooring, uPVC double-glazed obscured window, wash hand basin, toilet, heated towel rail, corner shower cubicle with glass doors, spotlights and floor-to-ceiling tiles.

Bedroom 2

9' 10" x 7' 6" (3.00m x 2.30m)

Fitted carpet, uPVC double-glazed window, ceiling light, multiple sockets and radiator.

Bedroom 3

7' 6" x 5' 10" (2.30m x 1.80m)

Fitted carpet, uPVC double-glazed window, ceiling light, sockets and radiator.

Bathroom

Luxury vinyl flooring, uPVC double-glazed obscured window, wash hand basin, toilet, electric shower over bath with glass screen, heated towel rail and floor-to-ceiling tiles.

Floorplans

GROUND FLOOR
395 sq.ft. (36.7 sq.m.) approx.

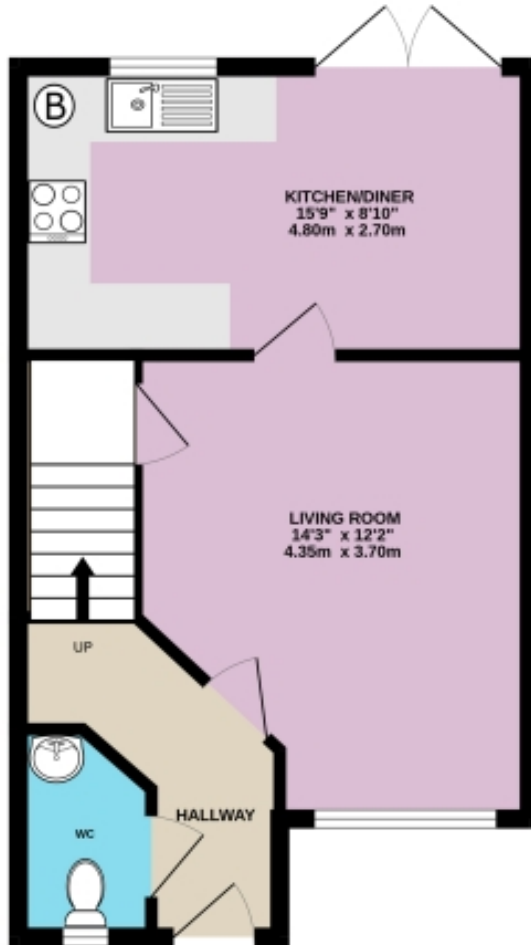

1ST FLOOR
366 sq.ft. (34.0 sq.m.) approx.

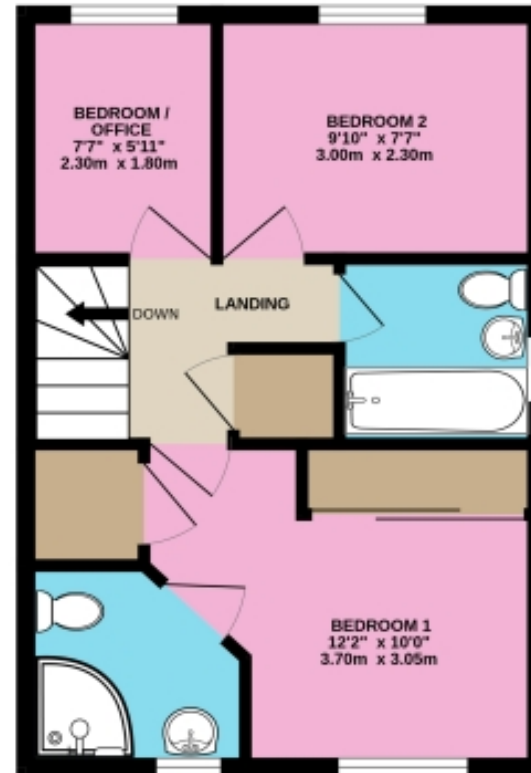

SEMI-DETACHED 3-BEDROOM HOUSE

TOTAL FLOOR AREA: 761 sq.ft. (70.7 sq.m.) approx.

Whilst every attempt has been made to ensure the accuracy of the floorplan contained here, measurements of doors, windows, rooms and any other items are approximate and no responsibility is taken for any error, omission or mis-statement. This plan is for illustrative purposes only and should be used as such by any prospective purchaser. The services, systems and appliances shown have not been tested and no guarantee as to their operability or efficiency can be given.
Made with Metropix ©2023

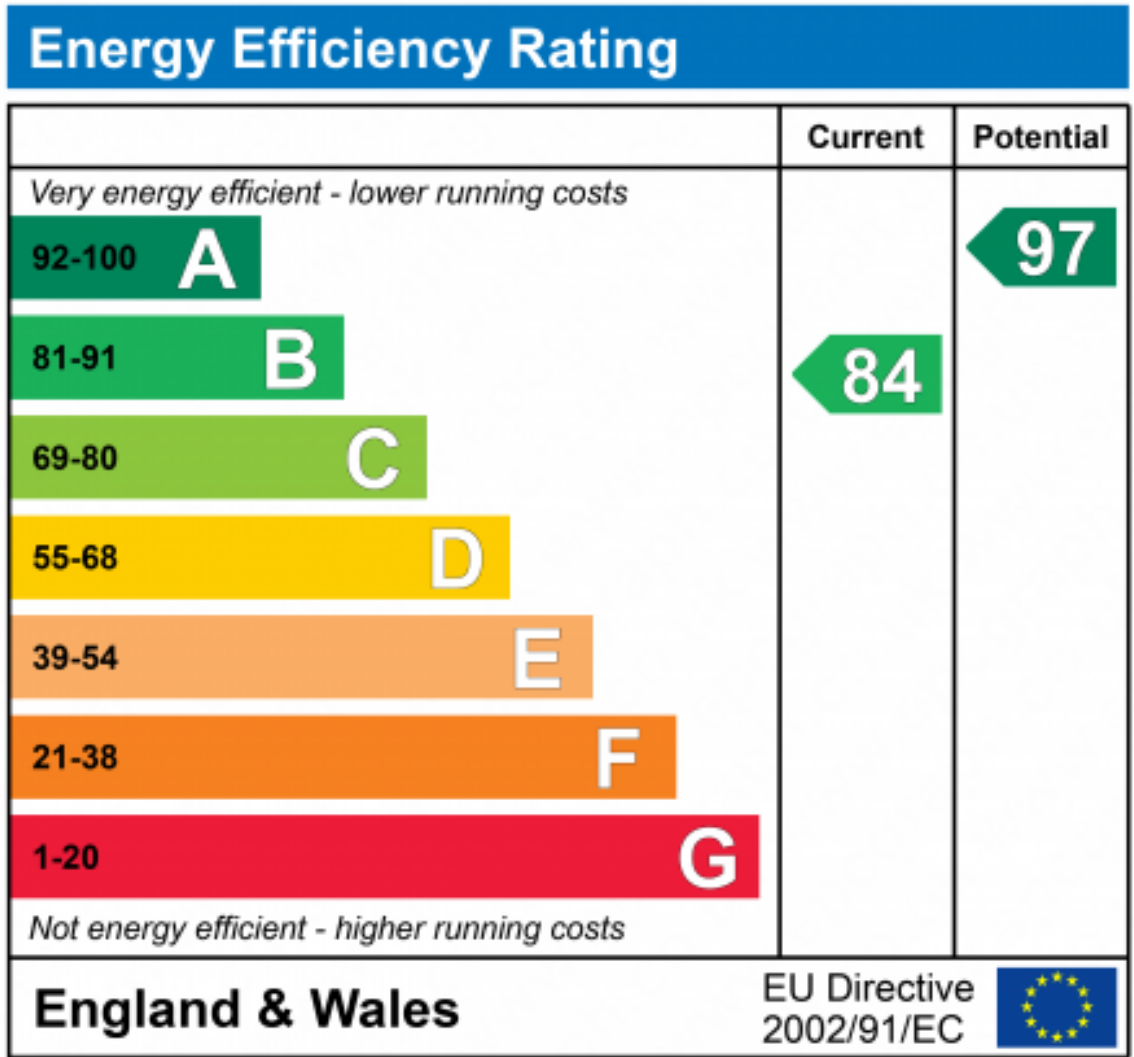



Marketed by Ewemove Wymondham

01953 665 785 (24/7)
wymondham@ewemove.com

