



Oak Avenue, Egham, TW20 8HH

O.I.E.O £425,000 F/H



Set on a generous plot, in a popular residential area just yards from local nurseries, schools and shops. Lyndhurst presents a rare opportunity to acquire a spacious four bedroom detached bungalow with immense potential. Though currently in a dilapidated state, the property offers a blank canvas for ambitious renovators, developers or those seeking to create a bespoke family home. No onward chain.

Lyndhurst, Oak Avenue, Egham, Surrey, TW20 8HH

FLOOR PLAN

Ground Floor

Approx. 117.1 sq. metres (1260.9 sq. feet)

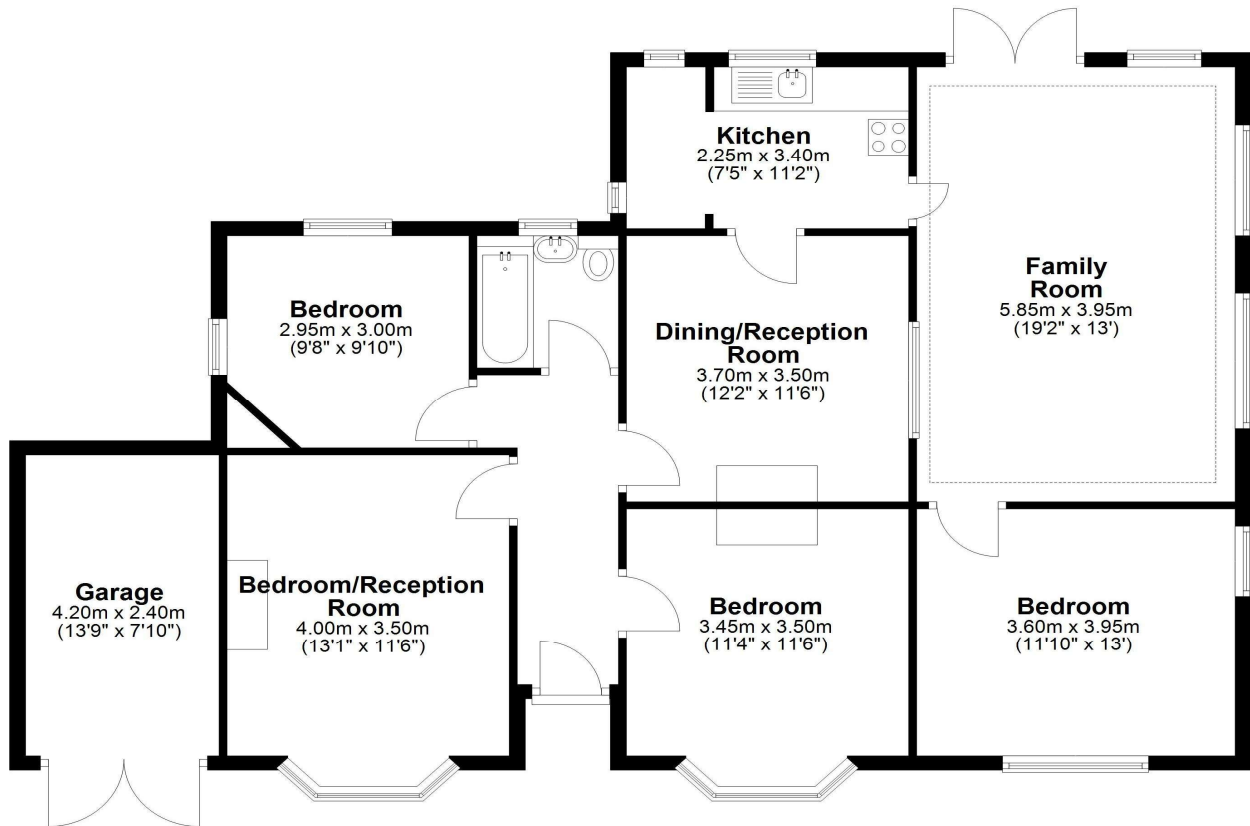

Total area: approx. 117.1 sq. metres (1260.9 sq. feet)

All measurements are approximate. Nevin & Wells Residential have not tested any systems or appliances.

EPC

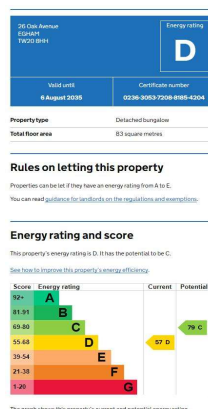

COUNCIL TAX BAND:

E - Runnymede Borough Council

VIEWINGS:

**By appointment with the clients selling agents,
Nevin & Wells Residential on 01784 437 437 or
visit www.nevinandwells.co.uk**

