

GREEN &
CO



£765,000 Eastridge Charlton Road, Wantage, Oxfordshire, OX12 8HG, UK

Freehold



GREEN &
CO

£765,000 Charlton Road, Wantage

Council Tax Band G

Occupying a generous plot of 0.37 acres (0.15 hectares) this handsome detached family residence has been much loved by one family for many years. It is now looking for its next custodian who will want to put their own mark upon it. Featuring flexible accommodation with a large attic which cries out to be converted to further living space, the property is just a short walk from the historic Market Place of Wantage, Waitrose and other local amenities, including Charlton Primary, Wantage Cricket Club and Wantage Silver Band's hall. With three reception rooms, a kitchen, cloakroom and conservatory on the ground floor, four bedrooms bathroom, shower room and separate WC on the first floor the property sits in attractive gardens which feature a shed and summerhouse and there is a garage and parking to the side. Offered for sale with no onward chain with a Grant of Probate already issued.

what3words. [w3w.co/dated.soaps.brass](https://www.what3words.co/dated.soaps.brass).

Tenure. Freehold.

Ofcom. For broadband speeds and mobile coverage, visit <https://www.ofcom.org.uk/>. If Rightmove has deleted this link, please click on the attached PDF brochure and follow the link provided there.

Utilities. All mains services are connected.

Heating Type. Gas-fired central heating to radiators.

Location. Wantage is a welcoming, well-connected Market Town that combines modern convenience with a strong sense of community, making it ideal for families



Green & Co. 33 Market Place Wantage OX12 8AL; t. 01235763562; e.sales@greenand.co.uk



looking to put down roots. Located in the beautiful Vale of the White Horse, the town offers easy access to the A34, M40, M4, and nearby rail services via Didcot, Oxford, and Swindon. A lively Market Place, packed with a mix of familiar names and independent shops, sits alongside family-friendly cafés, restaurants, parks, and community events. Surrounded by stunning countryside, from National Landscape (formerly AONB) and the Ridgeway to nearby White Horse Hill, Wantage offers space to explore, play, and grow. It's a Town where heritage, safety, and community spirit come together, making everyday family life feel both easy and inspiring. Families benefit from an excellent local education network. King Alfred's Academy leads secondary provision as part of the Cambrian Learning Trust, working closely with respected local primaries, including Charlton, Wantage CofE, and those not in the Trust at Stockham Primary School, and Wantage Primary Academy.





GREEN &
CO

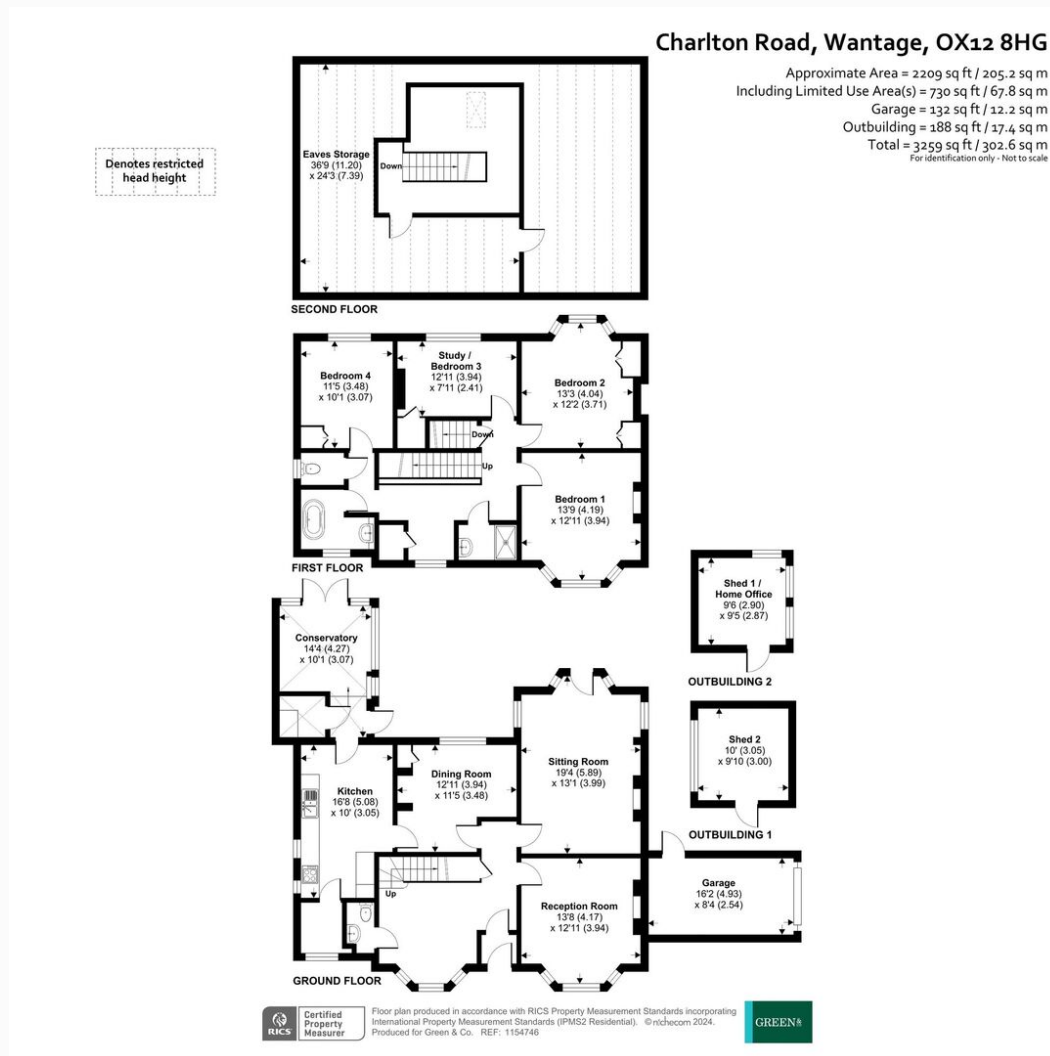

| Score | Energy rating | Current | Potential |
|-------|---------------|---------|-----------|
| 92+ | A | | |
| 81-91 | B | | |
| 69-80 | C | | 80 C |
| 55-68 | D | 64 D | |
| 39-54 | E | | |
| 21-38 | F | | |
| 1-20 | G | | |

Buyers must check the availability and/or any particular aspect of the property that could be of importance to them before booking an appointment to view or embarking on any journey to see it. Floor plans are provided entirely for illustrative purposes only and are NOT to scale. These particulars are copyright and are not to be reproduced in anyway without our written consent.

CONSUMER PROTECTION REGULATIONS AND UNFAIR TRADING REGULATIONS 2008

Green & Co has not tested any apparatus, equipment, fixtures and fittings or services and so cannot verify that they are in working order or fit for the purpose. References to the Tenure of a Property are based on information supplied by the Seller. We have not had sight of the title documents. Buyers should seek professional advice. Items shown in photographs are NOT included unless specifically mentioned within the sales particulars. Unless stated otherwise fitted carpets, curtains, window dressings, fixtures and fittings may not be included. However, they may be available by separate negotiation.

DATA PROTECTION ACT 2018

All handling of your personal data is done in compliance with our privacy policy and the General Data Protection Regulations (EU) 2016/679 ("Data Protection Legislation"). For full details of our privacy policy visit www.greenand.co.uk/primary-policy-and-notice.