KINGS LANGLEY ESTATES

S A L E S & L E T T I N G S

ARCHWAY HOUSE, 4 ORPHANAGE ROAD, WATFORD, WD17 1PG

PRICE UPON APPLICATION

WWW.KINGSLANGLEYESTATES.CO.UK

Kings Langley Estates are pleased to offer this spacious first floor apartment which is situated in a gated development within walking distance to Watford Junction Station and local amenities.

The accommodation comprises:

Entrance hallway, three bedrooms, bathroom and an open plan living room / kitchen. There is parking for residents to the rear of the development.

Viewings come strongly advised through the appointed Sole Agents.

360 walk through tour: [Click Here](#)

For more information please contact me on 01923 947373 or email: david@kingslangleyestates.co.uk



David Freeman
Director
Kings Langley Estates

WWW.KINGSLANGLEYESTATES.CO.UK

KINGS LANGLEY
ESTATES

SALES & LETTINGS



LET BY
0923 942

NO PARKING
24 Hour
Access Required







Kings Langley Estates wishes to inform prospective buyers and tenants that these particulars are a guide and act as information only. All our details are given in good faith and believed to be correct at the time of printing but they don't form part of an offer or contract. No employee of the company has authority to make or give a representation or warranty in relation to this property. All fixtures and fittings, whether fitted or not are deemed removable by the vendor unless stated otherwise and room sizes are measured between internal wall surfaces, including furnishings.

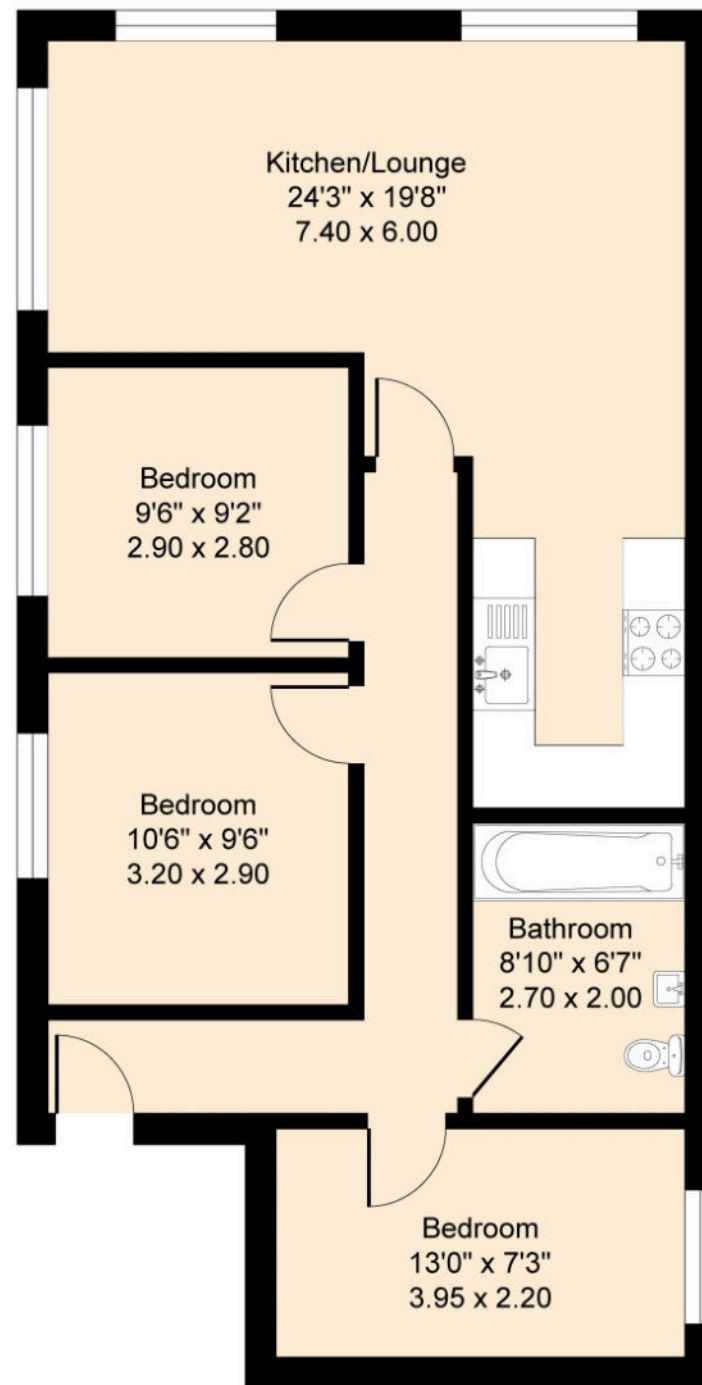

First Floor
Approximate Floor Area
71.38 sq. ft
(6.631 sq.m)

Flat 4 Archway Homes

Approximate Gross Internal Area = 6.631 sq m / 71.38 sq ft

Illustration for identification purposes only, measurements are approximate, not to scale





“My company was established in the Village in 2019. From the hard work & founding principles then - and both aspects have very much remained true to today - we quickly grew to become an award winning company in the local area. Our record in consistently handling the selling & Letting of properties brought to the market has been particularly impressive with a consistency demonstrable track record.”

D Freeman
DAVID FREEMAN
DIRECTOR



LOCAL AUTHORITY: WATFORD BOROUGH COUNCIL

VIEWINGS ADVISED VIA THE APPOINTED SOLE AGENTS

PRICE UPON APPLICATION



Kings House Business Centre, Home Park Estate, Station Road, Kings Langley, WD4 8LZ

Tel: 01923 947373

kingslangleyestates.co.uk