



Offers In The Region Of £360,000

4 Bedroom Detached House for sale
5 Sycamore Drive, South Molton





Overview

Introducing this executive-style, four-bedroom detached family home in the historic market town of South Molton, blending modern living with a charming local backdrop. Occupying a generous plot with a sunny south-facing garden, this double-fronted property offers both exceptional space and comfort-ideal for busy family life or those seeking to upgrade to larger surroundings.

SOME IMAGES HAVE BEEN STAGED TO ASSIST THE BUYER



Key Features

- MODERN 4 BEDROOM DETACHED HOME
- ENCLOSED SOUTH FACING REAR GARDEN
- SINGLE GARAGE AND DRIVEWAY
- SOLAR PANELS
- CENTRE AND LOCAL SCHOOLS
- REMAINDER OF NHBC WARRANTY
- WHAT3WORDS///reflected.unsightly.spared







Nestled in the heart of the historic market town of South Molton, 5 Sycamore Drive presents an exceptional opportunity to secure a well-presented, executive-style detached family home. Designed with both comfort and environmental efficiency in mind, this beautifully appointed residence comes complete with solar panels and the remainder of its NHBC warranty, offering peace of mind for years to come.

Inside, this generously proportioned four-bedroom home provides flexible living space perfect for modern family life. The impressive double-fronted façade opens into a large entrance hall, welcoming you to spacious surroundings and a lovely sense of flow. An open-plan lounge and dining area benefits from classy double-aspect windows, an elegant fireplace, and direct access through patio doors to the enclosed, south-facing garden – ideal for summer entertaining. The dining space comfortably seats six, making it the ultimate hub for family gatherings or dinner parties.

The contemporary kitchen/breakfast room is fitted with high-quality built-in appliances and offers a bespoke dining nook for casual meals. Off the kitchen, a handy utility room leads straight into the garden while providing ample space for regularly used essentials such as the washing and drying machines.

Upstairs, landing leads the way to a serene master suite featuring a king-size bedroom and its own bright, modern en-suite. Across the hall you'll find a second spacious king-sized bedroom with airing cupboard storage, two further double bedrooms, and a contemporary family bathroom fully equipped for a growing household.

Set on a generous plot, this property boasts a single garage plus a driveway which can be accessed conveniently from the garden side door. The enclosed rear garden enjoys plenty of light and space, offering the perfect environment for children to play or for al fresco relaxation.

South Molton itself is famous for its welcoming community spirit and offers everything a family could require within easy walking distance. Explore the vibrant town square filled with weekly markets, browse local independent shops, and enjoy delicious fare in the area's cafes and friendly pubs. Educational opportunities are numerous thanks to outstanding local schools, and superb transport links place both Station Road connections and the picturesque Exmoor National Park mere minutes from your new doorstep – perfect for countryside escapes.



If your search is for a substantial and well-presented family home in a highly regarded location, 5 Sycamore Drive is not to be missed. Contact us today to arrange your viewing and take the next step towards your dream move.

Floorplans



Floorplans

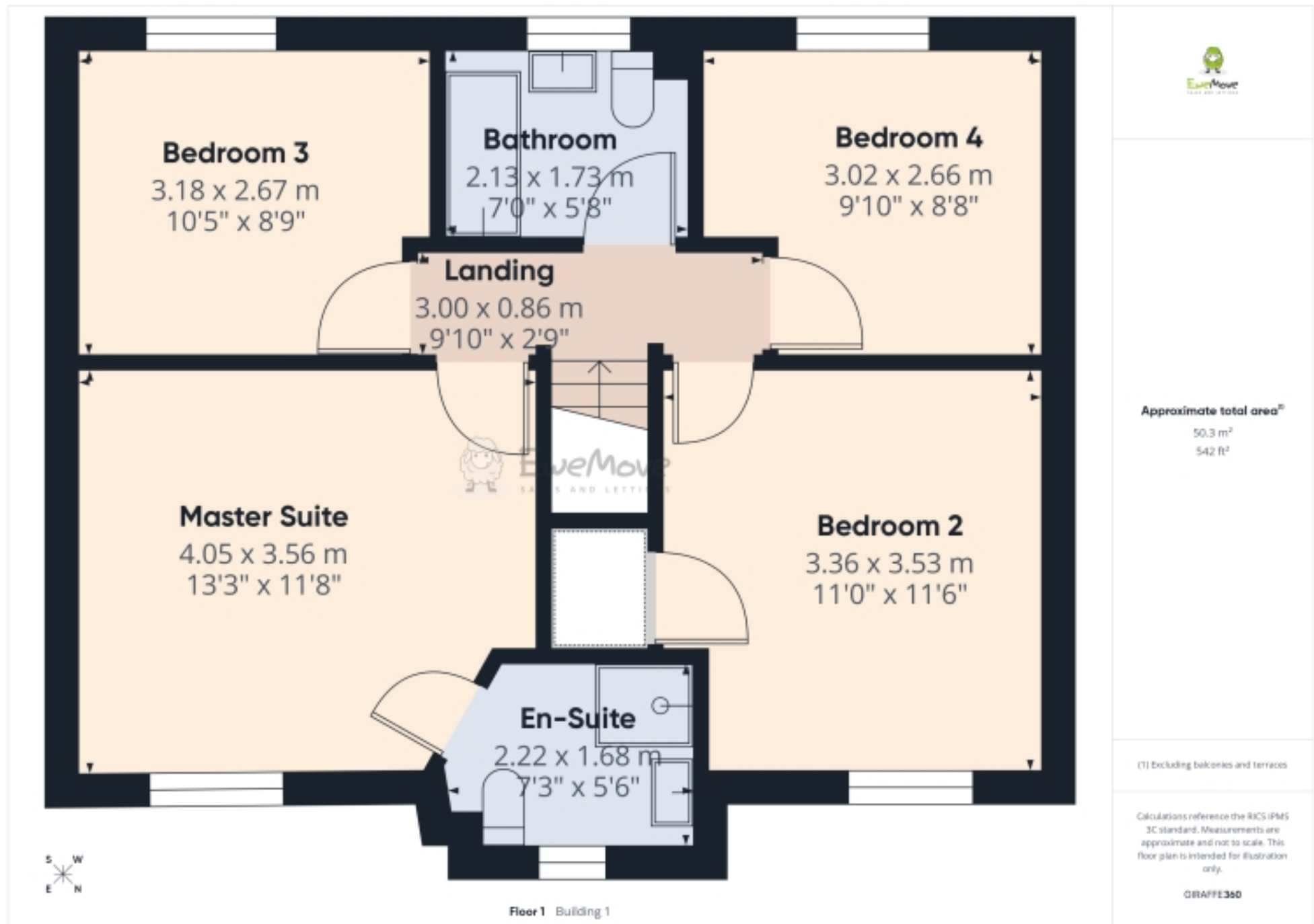

Floorplans



EPC

Score	Energy rating	Current	Potential
92+	A		92 A
81-91	B	91 B	
69-80	C		
55-68	D		
39-54	E		
21-38	F		
1-20	G		



Marketed by EweMove South Molton

01769 611 444 (24/7)
southmolton@ewemove.com

