

Hellards



At home in Alresford

Room 9, Bailey House

ALRESFORD, HAMPSHIRE, SO24 9JG

Asking Rent £ 1,420 PCM

- Retirement Home
- Holding Deposit £327.69
- Deposit £1638.45
- Rent includes all meals and utility bills
- First floor room
- Private en-suite shower room
- Lift Access
- Communal Sitting and Dining Room
- Communal Conservatory and Garden



An unique opportunity to rent an en-suite room in a small Sheltered Housing development in the centre of Alresford which is ideal for someone in later life who wish to maintain their independence, but in a supported environment with other like-minded people.





This first floor room is dual aspect, with built in storage and space for a fridge, microwave and kettle. There is a modern en-suite shower room. There is a lift up to the first floor, and all doors in the building have automatic opening and closing.

Bailey House consists of 10 rooms, along with a communal sitting / dining room, conservatory and laundry room. There is also a pleasant garden for resident's use. The rent includes two home cooked meals a day, and all utilities.

Alresford is a beautiful Georgian town known for its variety of independent shops, restaurants and inns located in stunning surroundings on the edge of the South Downs National Park. Attractions include the Watercress steam railway, schools for infant, junior and secondary education, several churches and an active and inclusive community. The cathedral city of Winchester is about 7 miles away and there is easy access to the south coast, the midlands and London via the road network. There is also mainline rail access to London from both Winchester and Alton. Southampton airport is only about half an hour away by car.



DIRECTIONS

From our Office in Broad Street, turn right into Broad Street, and then right again into West Street. Turn left into Station Road by the Swan Hotel and continue along, where Bailey House can be found on the right hand side, between Alders Court and the Surgery.

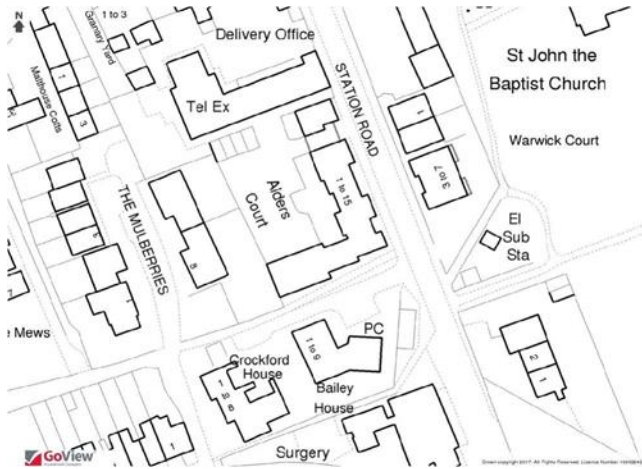

1ST FLOOR
172 sq.ft. (16.0 sq.m.) approx.

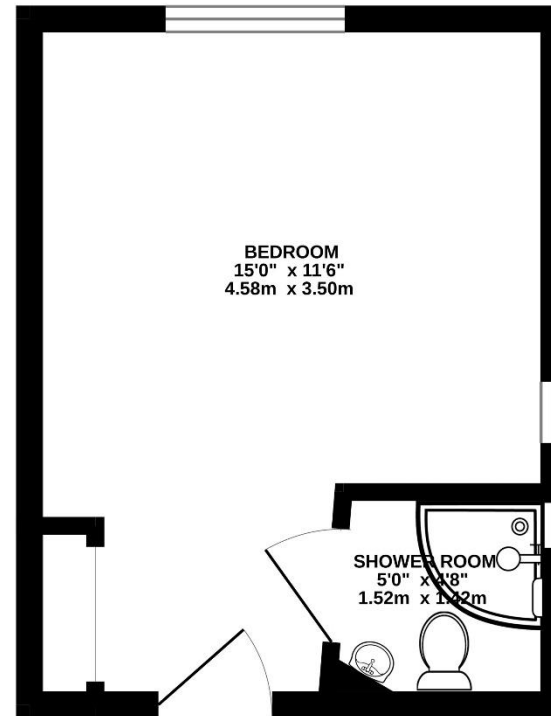

TOTAL FLOOR AREA: 172 sq.ft. (16.0 sq.m.) approx.
 Whilst every attempt has been made to ensure the accuracy of the floorplan contained here, measurements of doors, windows, rooms and any other items are approximate and no responsibility is taken for any error, omission or mis-statement. This plan is for illustrative purposes only and should be used as such by any prospective purchaser. The services, systems and appliances shown have not been tested and no guarantee as to their operability or efficiency can be given.
 Made with Metropix ©2023

No. 11 Broad Street, Alresford, Hampshire, SO24 9AR

01962 736333

lettings@hellards.co.uk | hellards.co.uk

IMPORTANT: we would like to inform prospective purchasers that these sales particulars have been prepared as a general guide only. A detailed survey has not been carried out, nor the services, appliances and fittings tested. Room sizes should not be relied upon for furnishing purposes and are approximate. If floor plans are included, they are for guidance only and illustration purposes only and may not be to scale. If there are any important matters likely to affect your decision to buy, please contact us before viewing the property.

