

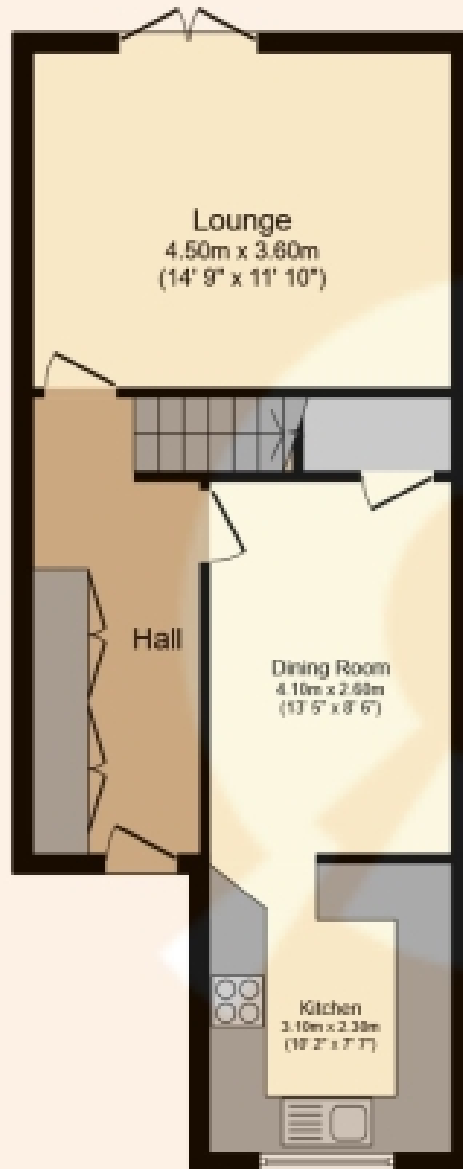

9 Bellmans Close, Beith

Offers Over £105,000





Ground Floor

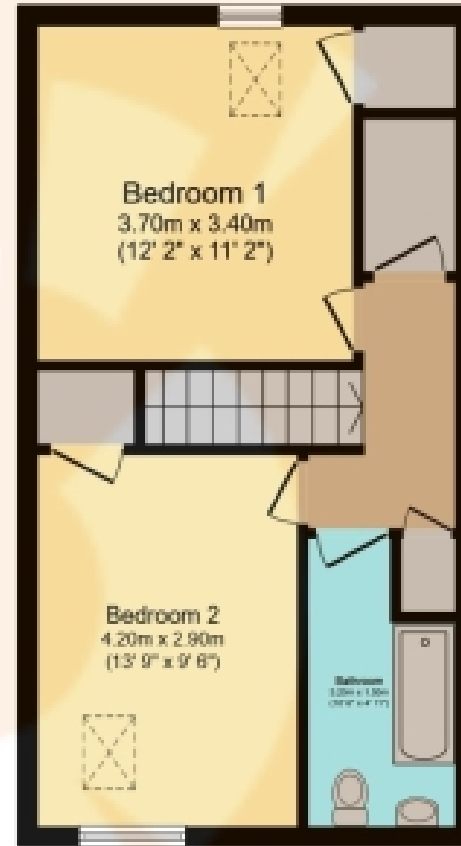

First Floor

Total floor area 85.7 sq.m. (923 sq.ft.) approx

This plan is for illustration purposes only and may not be representative of the property. Plan not to scale. Powered by PropertyBox

THE PROPERTY

**** SPACIOUS, EXTENDED MID-TERRACE HOME SITUATED IN SOUGHT AFTER LOCALE**RECENTLY INSTALLED & EXTENDED DINING KITCHEN ** PATIO DOORS OFFERING DIRECT GARDEN ACCESS ** NEW GCH BOILER **. View in Person or Online. Please contact your personal estate agents, The Property Boom, for much more information and a copy of the Home Report.**

Welcome to your dream home – No. 9 Bellmans Close. Indulge in the enchanting charm of this delightful mid-terrace family home, nestled in a highly sought-after locale. With a perfect blend of warmth and character, this property is sure to appeal to a wide range of purchasers to include first-time buyers, growing families, and professionals alike.

Step inside and be greeted by a bright and airy lounge, where natural light engulfs the room. Open the patio doors and discover a seamless connection between indoor and outdoor living, leading you to a picturesque garden and a sociable patio area. Imagine lazy summer days spent basking in the sun or entertaining friends and family.

The kitchen is a masterpiece, recently installed and extended with contemporary fittings and boasting integrated appliances that cater to your every culinary need. Prepare gourmet meals while soaking in the beauty of this modern space. Open plan to the kitchen is a delightful dining room, providing ample space for gatherings and creating cherished memories.

This family home generously offers two perfectly proportioned bedrooms, each designed with your comfort in mind. Built-in storage ensures a clutter-free environment. The partially tiled bathroom exudes elegance, featuring contemporary fixtures and fittings which add a touch of sophistication to your daily routine.

Additional features of this remarkable property include gas central heating and double glazing throughout, ensuring year-round comfort and energy efficiency. Situated in the picturesque town of Beith, you'll find yourself surrounded by an array of local amenities, shops, and convenient transport links.

The town boasts excellent transport links, connecting residents to nearby cities and towns. Whether you're commuting or exploring the surrounding areas, convenient bus and train services provide easy access to Glasgow, Paisley, and other nearby destinations. Embrace the beauty of Beith while enjoying seamless connectivity to urban centers, making it an ideal location for those seeking a perfect balance between rural serenity and urban convenience.

Whether you choose to visit this enchanting home in person or take a virtual tour, prepare to fall in love with its irresistible charm. Don't miss the opportunity to make this captivating property your forever haven. Contact us today to arrange your viewing, either in person or online. Experience the magic for yourself!

Viewing by appointment - please contact The Property Boom to arrange a viewing or for any further information and a copy of the Home Report. Any areas, measurements or distances quoted are approximate and floor Plans are only for illustration purposes and are not to scale. Thank you. THESE PARTICULARS ARE ISSUED IN GOOD FAITH BUT DO NOT CONSTITUTE REPRESENTATIONS OF FACT OR FORM PART OF ANY OFFER OR CONTRACT.

www.thepropertyboom.com
70 West Regent Street, Glasgow, G2 2QZ
Tel: 0333 900 9089 / Email: smile@thepropertyboom.com