



Staines Road West, Ashford, TW15 1RB

£4,000 pcm Guide Price



Situated within an electronic gated entrance, is this recently refurbished and extremely spacious five double bedroom detached house. The property hosts three en-suites, walk in-wardrobe to principal suite, modern kitchen with separate utility and large 'L' shape lounge/diner with doors onto a private garden. In addition there is a full width outbuilding with wash facilities, ideal for visiting guests. With parking for several vehicles, this property ticks all the boxes !

AVAILABLE NOW - Unfurnished

Staines Road West, Ashford, Middlesex, TW15 1RB

FLOORPLAN

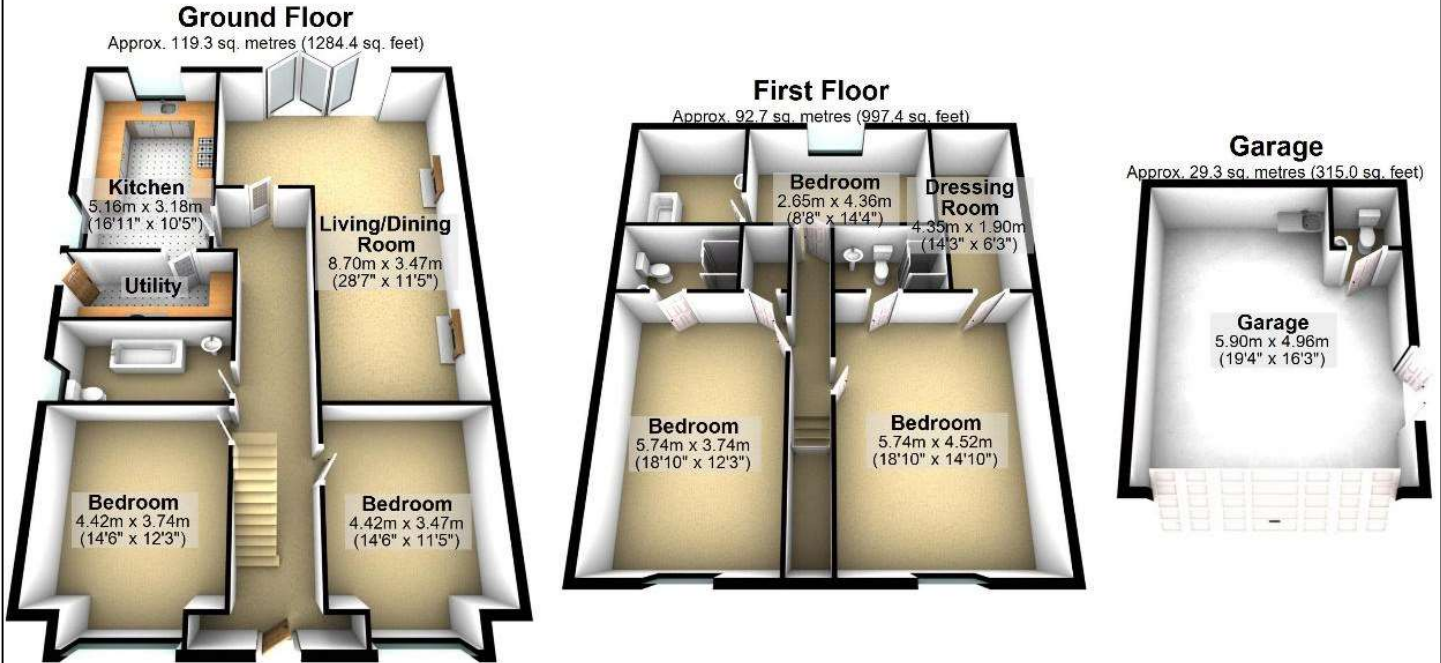

Total area: approx. 241.3 sq. metres (2596.8 sq. feet)

EPC

399 Staines Road West ASHFORD TW15 1RB		Energy rating C
Valid until 23 January 2033	Certificate number 8300-3543-0022-4229-3973	

Property type	Detached bungalow
Total floor area	194 square metres

Rules on letting this property

Properties can be let if they have an energy rating from A to E.
You can read [guidance for landlords on the regulations and exemptions](#).

Energy rating and score

This property's current energy rating is C. It has the potential to be C.
[See how to improve this property's energy efficiency.](#)

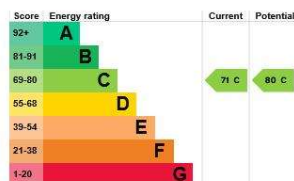

The graph shows this property's current and potential energy rating.

Properties get a rating from A (best) to G (worst) and a score. The better the rating and score, the lower your energy bills are likely to be.

For properties in England and Wales:

- the average energy rating is D
- the average energy score is 60

COUNCIL TAX BAND:

F - Spelthorne Borough Council