

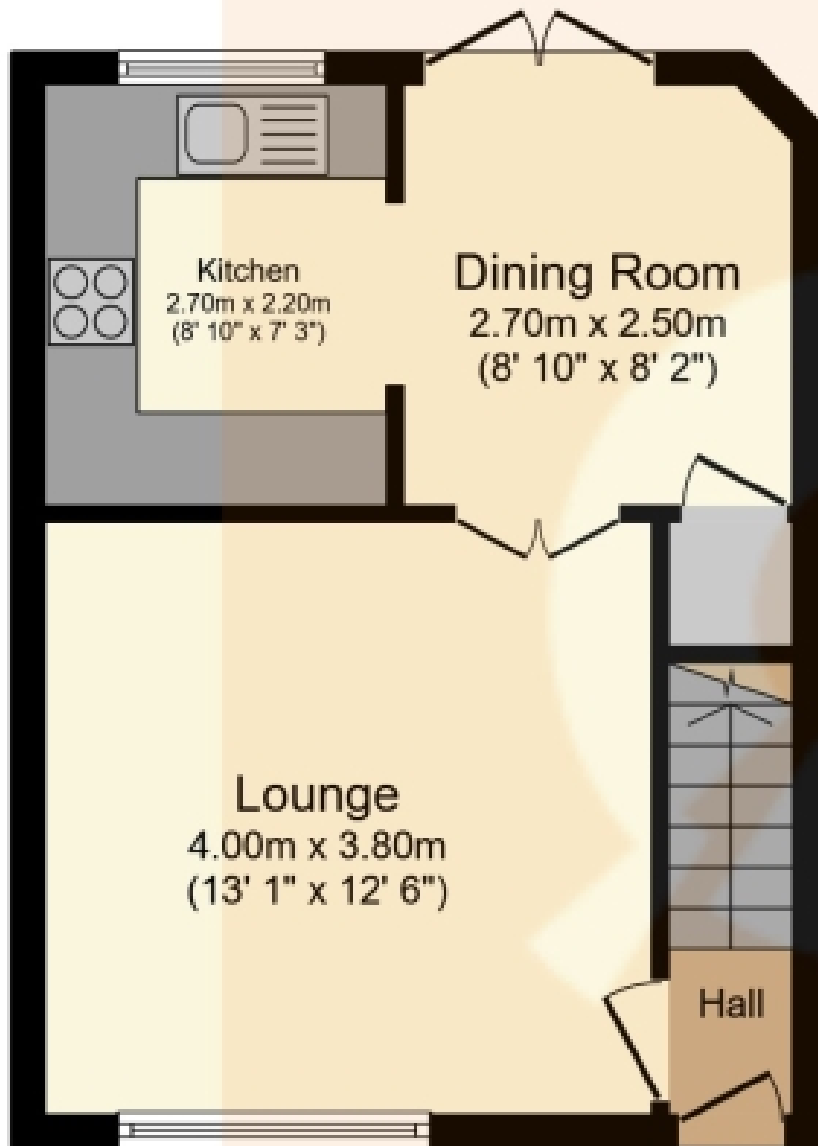

**93 Nethergreen Wynd, Renfrew**

**Offers Over £199,995**





**Ground Floor**

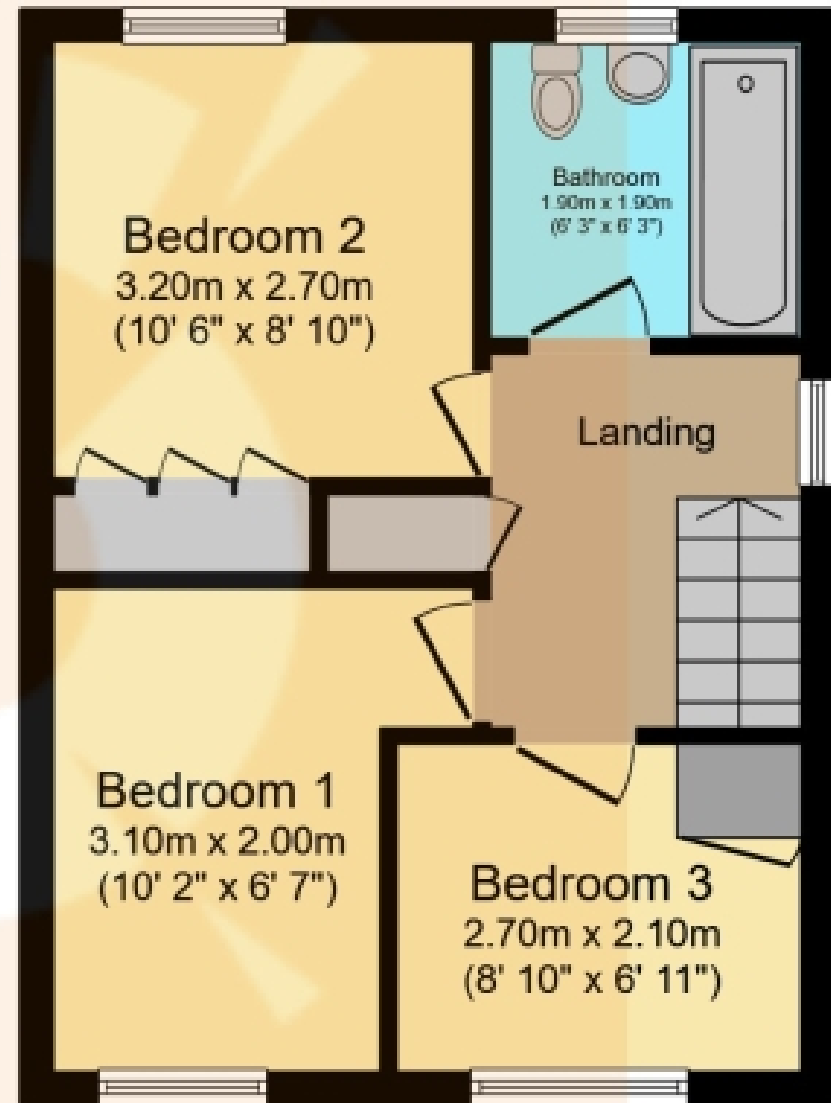

**First Floor**

Total floor area 63.3 sq.m. (681 sq.ft.) approx

This plan is for illustration purposes only and may not be representative of the property. Plan not to scale. Powered by PropertyBox

## THE PROPERTY

**\*\* WALK-IN CONDITION \*\* SOUGHT-AFTER RENFREW ESTATE \*\* RECENTLY INSTALLED FAMILY BATHROOM \*\* WELL-APPOINTED KITCHEN – ALL WHITE GOODS INCLUDED WITHIN SALE \*\* NEW DOUBLE GLAZING \*\* MANICURED REAR GARDEN \*\***. View in Person or Online. Please contact your personal estate agents, The Property Boom, for much more information and a copy of the Home Report.

Welcome to No. 93 Nethergreen Wynd and this wonderful family home set within a sought-after Renfrew estate. No stone has been left unturned with the presentation of this property, making it an excellent opportunity for a range of purchasers to include first-time buyers, growing families, and professionals alike.

Externally, the property boasts a low maintenance front garden which is predominantly laid to lawn with driveway, providing safe off-street parking. Upon entering, a bright and airy reception hallway leads you through to the family lounge which has been presented with contemporary wall coverings and fitted carpets. This entire space is filled with an abundance of natural sunlight, enhancing the feeling of bright airy spaciousness that you get when you first enter the property.

The modern fitted kitchen offers ample oak-effect wall and base mounted units coupled perfectly with contrasting granite-effect work tops, creating both a stylish and efficient workspace. Integrated appliances include a 4-ring gas hob, electric oven/grill, extractor hood, dishwasher, washing machine, and there is a free-standing fridge/freezer. All white goods will be included within the sale, making this a fantastic first-time purchase.

Completing the ground floor is a charming dining room, offering the perfect space to enjoy a home-cooked meal with family. Chic French doors provide direct access to the beautifully landscaped rear garden which is fully enclosed, creating a safe and secure environment for children and pets alike. The large sociable decking area with in-built LED lighting offering a great space for outdoor entertaining/dining alfresco.

On to the upper level there are three generous bedrooms. Bedroom one offers fabulous built-in storage with sliding wardrobes. Completing the home internally is the recently installed, ultra-modern family bathroom, fitted with high quality chrome fixtures and fittings throughout.

Gas-central heating and recently installed double glazing can be found throughout, providing all rooms with a lovely warmth.

Renfrew has an eclectic range of shops to include the popular Braehead Shopping Centre and plentiful restaurants and bars within XSite, both only a 5-minute drive away. Renfrew Town Centre is home to many supermarkets and local shops, restaurants, bars, takeaways, hairdressers/barbers and lots more. Glasgow International Airport and the Queen Elizabeth University Hospital are a short drive away and the nearby M8 motorway provides quick and easy access to Glasgow City Centre and further afield.

For more detailed information on schooling, please use The Property Boom's catchment and performance tool on our website. Viewing is by appointment - please contact your personal estate agents, The Property Boom to arrange a viewing or for any further information and a copy of the Home Report.

Any areas, measurements or distances quoted are approximate and floor Plans are only for illustration purposes and are not to scale. THESE PARTICULARS ARE ISSUED IN GOOD FAITH BUT DO NOT CONSTITUTE REPRESENTATIONS OF FACT OR FORM PART OF ANY OFFER OR CONTRACT.

[www.thepropertyboom.com](http://www.thepropertyboom.com)  
70 West Regent Street, Glasgow, G2 2QZ  
Tel: 0333 900 9089 / Email: [smile@thepropertyboom.com](mailto:smile@thepropertyboom.com)