



Wesley Drive, Egham, TW20 9JA

£2,000pcm Guide Price



Located in central Egham close to local schools, High Street amenities and mainline train station is this recently refurbished three bedroom detached residence, benefitting from own driveway, garage, entrance hallway, lounge, dining room, kitchen, utility room, downstairs W.C, first floor bathroom and private rear garden.

AVAILABLE 4th DECEMBER 2023 - Unfurnished

Wesley Drive, Egham, Surrey, TW20 9JA

GROUND FLOOR

1ST FLOOR

FLOORPLAN

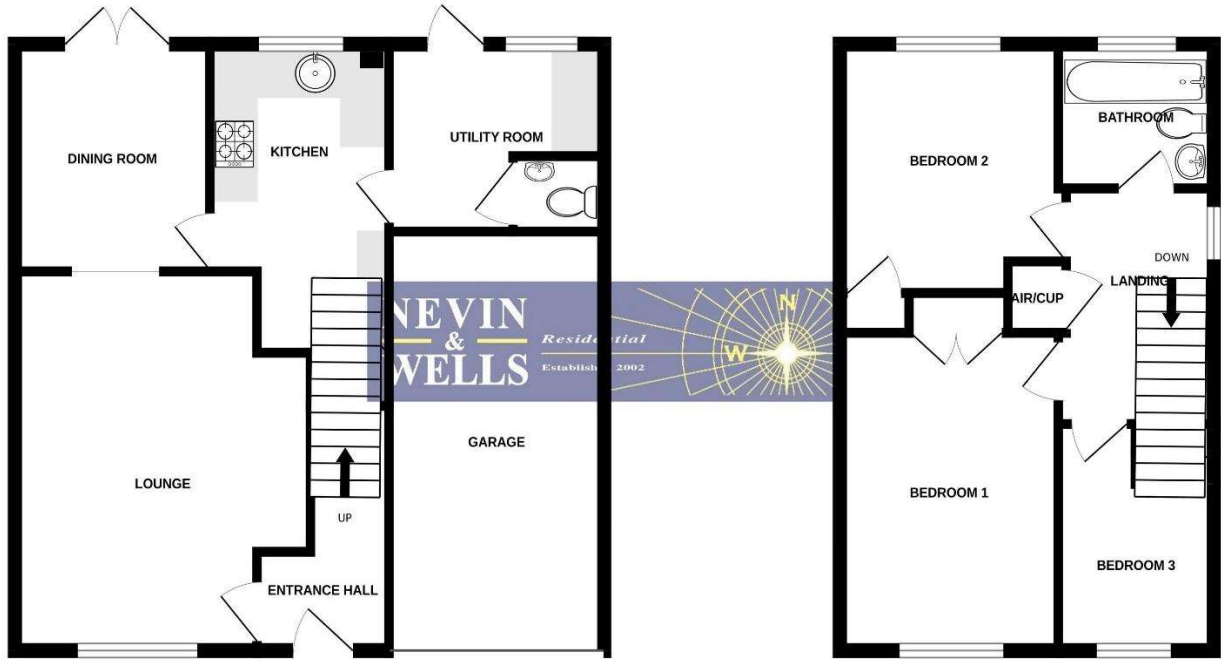

Whilst every attempt has been made to ensure the accuracy of the floorplan contained here, measurements of doors, windows, rooms and any other items are approximate and no responsibility is taken for any error, omission or mis-statement. This plan is for illustrative purposes only and should be used as such by any prospective purchaser. The services, systems and appliances shown have not been tested and no guarantee as to their operability or efficiency can be given.
Made with Metropix ©2023

EPC

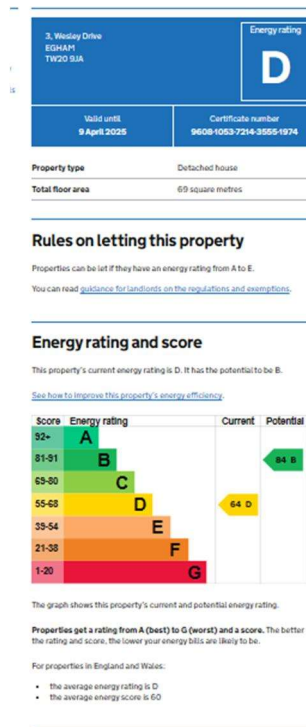

COUNCIL TAX BAND: E - Runnymede Borough Council