

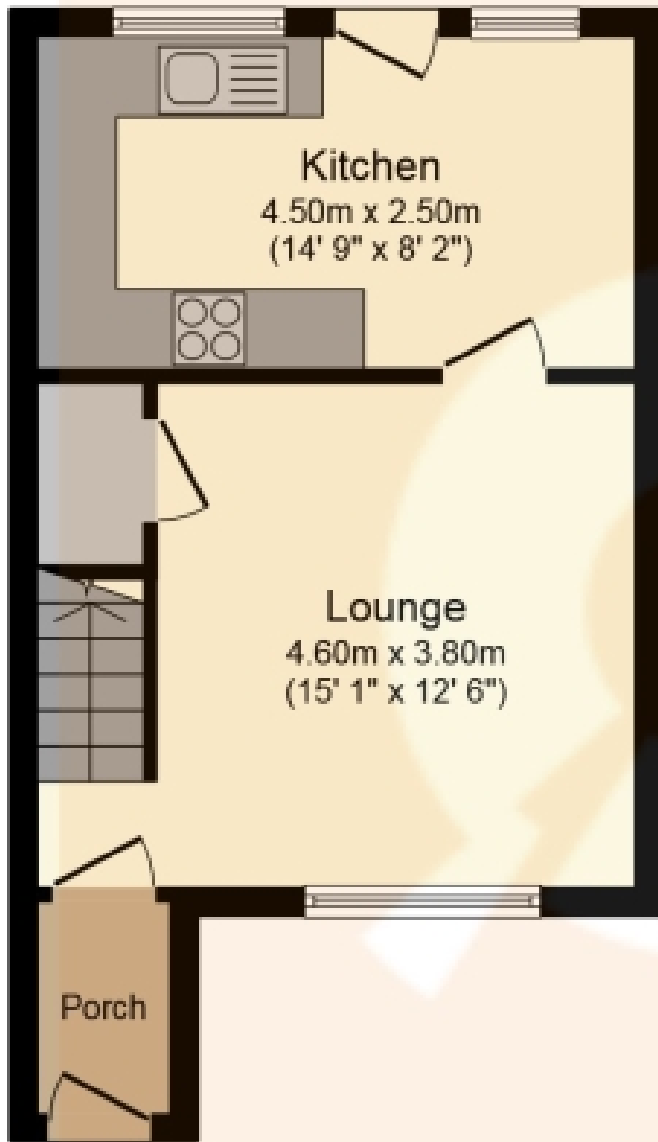

109 Fisher Drive, Paisley

Offers Over £145,000





Ground Floor

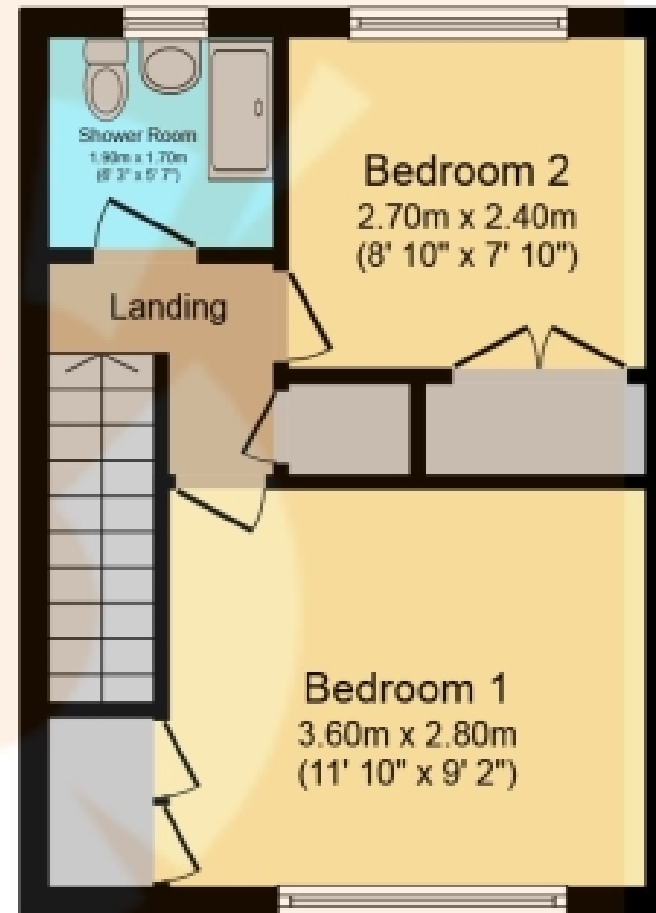

First Floor

Total floor area 59.3 sq.m. (638 sq.ft.) approx

This plan is for illustration purposes only and may not be representative of the property. Plan not to scale. Powered by PropertyBox

THE PROPERTY

DELIGHTFUL SEMI-DETACHED VILLA. Are you in search of your dream home? Look no further! This modern semi-detached villa in the heart of Paisley is a gem that offers you the lifestyle you've always desired. MODERN DINING KITCHEN. Presented immaculately throughout.

Step into style and modern refinement as you enter this beautiful home through the welcoming vestibule. A cozy Living Room with an abundance of spaciousness and natural light is perfect for relaxing and unwinding and provides a warm and inviting atmosphere for family and friends. Furniture can be included in the sale if required.

The ultra-modern Fitted Kitchen at the heart of the home. Enjoy meals in style with all the necessary amenities at your fingertips. With ample space for dining, the super stylish kitchen is the perfect place for entertaining guests. The dining table and appliances can also be included making this property a very attractive purchase for a first-time buyer or investor.

Your private sanctuaries await! Two generously sized bedrooms with fitted wardrobes offer ample storage and comfort. The modern shower room features a three-piece suite, ensuring your mornings start with luxury.

Welcome to your very own outdoor paradise! The property boasts excellent gardens, perfect for gardening enthusiasts or for children to play. Plus, a large front and side driveway ensures parking is never an issue.

Gas Central Heating & Double Glazing: Stay cozy and energy-efficient all year round with the benefits of gas central heating and double glazing.

This property is conveniently located near Paisley's thriving amenities. Enjoy the convenience of the nearby Phoenix Retail Park, offering a wide selection of shops and even a cinema for your entertainment. Local transport links provide quick and easy access to the surrounding areas, making your daily commute a breeze.

Don't Miss Out - Viewing Strongly Recommended: This modern semi-detached villa is the epitome of style, comfort, and convenience. Whether you're a first-time buyer, a growing family, or looking to downsize, this property caters to all. Don't miss the chance to make it your forever home.

Contact Boom now to schedule a viewing and experience the beauty and serenity of this exceptional property. Your dream home awaits - seize this opportunity today!

Viewing by appointment - please contact The Property Boom to arrange a viewing or for any further information and a copy of the Home Report. Any areas, measurements or distances quoted are approximate and floor Plans are only for illustration purposes and are not to scale.

THESE PARTICULARS ARE ISSUED IN GOOD FAITH BUT DO NOT CONSTITUTE REPRESENTATIONS OF FACT OR FORM PART OF ANY OFFER OR CONTRACT.

www.thepropertyboom.com
70 West Regent Street, Glasgow, G2 2QZ
Tel: 0333 900 9089 / Email: smile@thepropertyboom.com