

Mill House Lane, TW20 8QS

O.I.E.O £500,000 F/H



This charming character cottage located in the historic village of Thorp, features a large reception room with a charming fireplace, spacious eat in kitchen, pantry/utility room, three bedroom and two bathrooms. The cottage also boasts front and rear gardens, offering a peaceful retreat in the heart of the village. No onward chain.

Greenwood, Mill House Lane, Thorpe, Surrey, TW20 8QS

FLOOR PLAN

GROUND FLOOR
721 sq.ft. (67.0 sq.m.) approx.

1ST FLOOR
297 sq.ft. (27.6 sq.m.) approx.

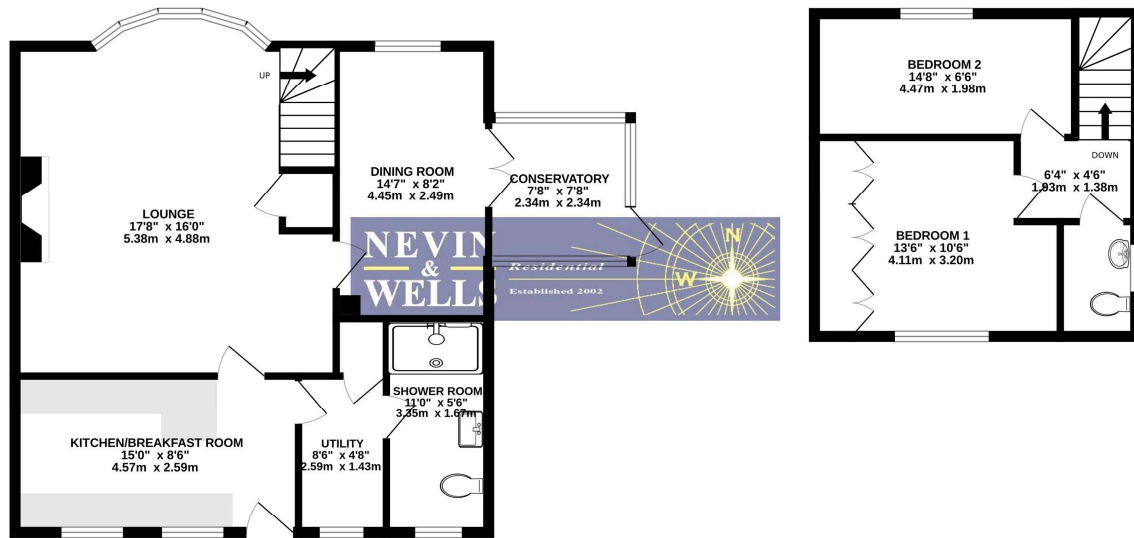

TOTAL FLOOR AREA : 1018 sq.ft. (94.6 sq.m.) approx.

Whilst every attempt has been made to ensure the accuracy of the floorplan contained here, measurements of doors, windows, rooms and any other items are approximate and no responsibility is taken for any error, omission or mis-statement. This plan is for illustrative purposes only and should be used as such by any prospective purchaser. The services, systems and appliances shown have not been tested and no guarantee as to their operability or efficiency can be given.
Made with Metropix 5/2025

All measurements are approximate. Nevin & Wells Residential have not tested any systems or appliances.

AWAITING EPC

COUNCIL TAX BAND:

D - Runnymede Borough Council

VIEWINGS:

**By appointment with the clients selling agents,
Nevin & Wells Residential on 01784 437 437 or
visit www.nevinandwells.co.uk**

