

Green Road, Thorpe, Surrey, TW20 8QS

£575,000 F/H

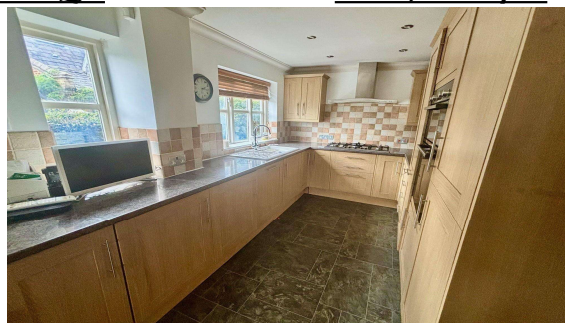

Wisteria house, a beautifully built three bedroom semi detached residence that blends contemporary design set in historic surroundings. Situated within the heart of Thorpe Village, this rarely available property is located within just yards of local schools, nurseries, post office, play parks and open green areas.

Green Road, Thorpe, Surrey, TW20 8QS

FLOOR PLAN

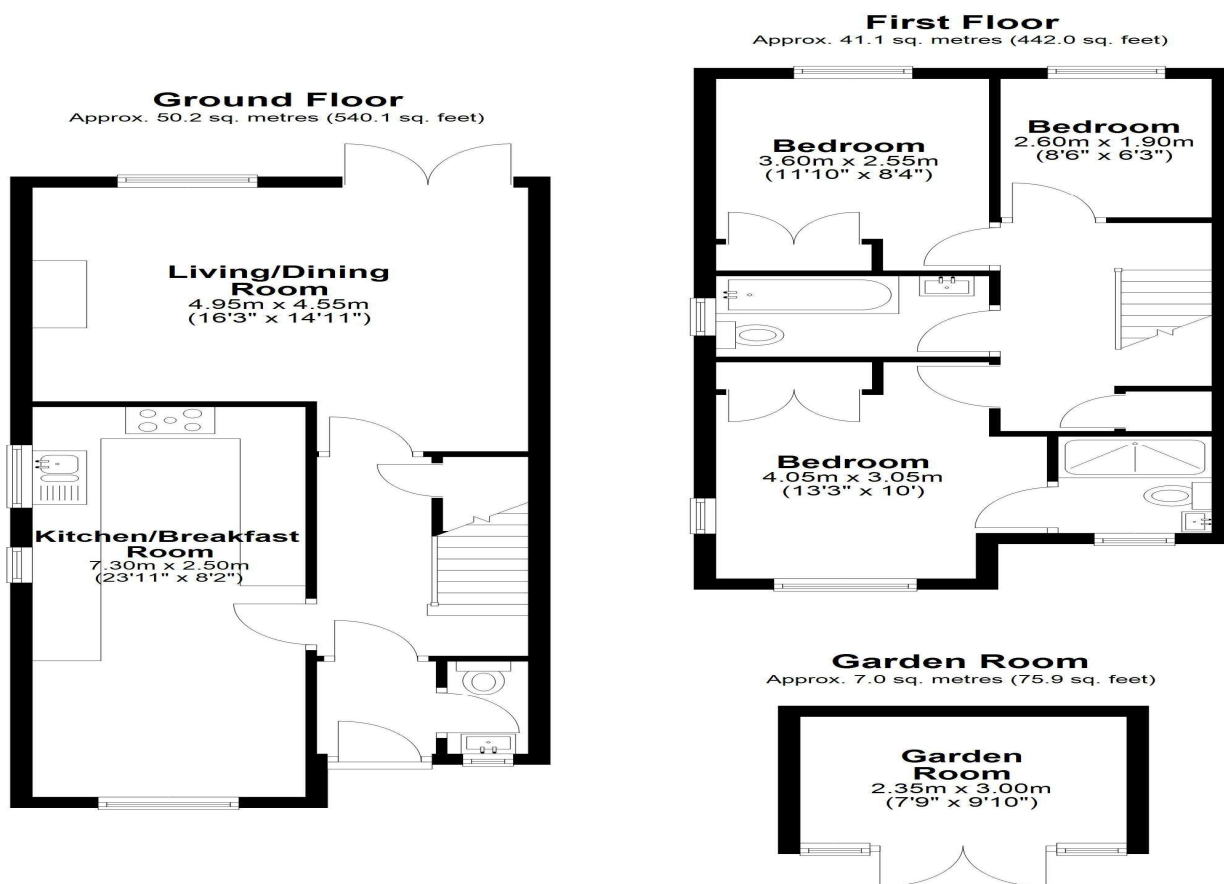

Total area: approx. 98.3 sq. metres (1057.9 sq. feet)

All measurements are approximate. Nevin & Wells Residential have not tested any systems or appliances.

EPC

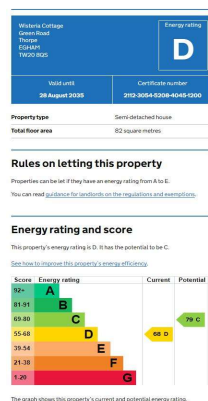

COUNCIL TAX BAND:

E - Runnymede Borough Council

VIEWINGS:

By appointment with the clients selling agents,
Nevin & Wells Residential on 01784 437 437 or
visit www.nevinandwells.co.uk

