



Guide Price £190,000

1 Bedroom Ground Floor Flat for sale
20 Marsden Gardens, Dartford



EweMove
SALES AND LETTINGS



Overview

Guide Price £190,000 - £200,00 Nestled within Dartford's sought-after Bridge Development, this 1 bedroom ground floor flat presents a delightful living opportunity. Boasting a spacious double bedroom and a generously sized kitchen-living area, this residence offers comfortable and functional living spaces.



Key Features

- Call NOW 24/7 or go Online to Book
- Long 111 Year Lease
- Double Bedroom
- Good Primary and Secondary School on Development
- 1 Allocated Parking Space
- Very Popular Location
- Close to Local Parks
- Close to Local Amenities



Guide Price £190,000 - £200,00 Nestled within Dartford's sought-after Bridge Development, this 1 bedroom ground floor flat presents a delightful living opportunity. Boasting a spacious double bedroom and a generously sized kitchen-living area, this residence offers comfortable and functional living spaces.

A well-appointed bathroom and the convenience of a designated parking space add to the appeal. Secure entry via the phone system ensures peace of mind, while the recent installation of a new gas boiler ensures efficient heating.

The property's prime location provides easy access to local transport links, including a dedicated bus lane with services connecting Dartford Station, Dartford High Street, Greenhithe Station, and Bluewater Shopping Centre. Minor enhancements such as painting and flooring would further enhance this already appealing property.

In conclusion, this ground floor apartment within the Bridge Development presents a unique opportunity to embrace contemporary and comfortable living in the heart of Dartford, Kent. Please go to our website to book your immediate accompanied viewing with live viewing slots available.

Please note: this property is fully EWS1 compliant with the EWS1 certificate for the block available on request.



Bedroom

Bathroom

Living Room

Kitchen

Floorplans

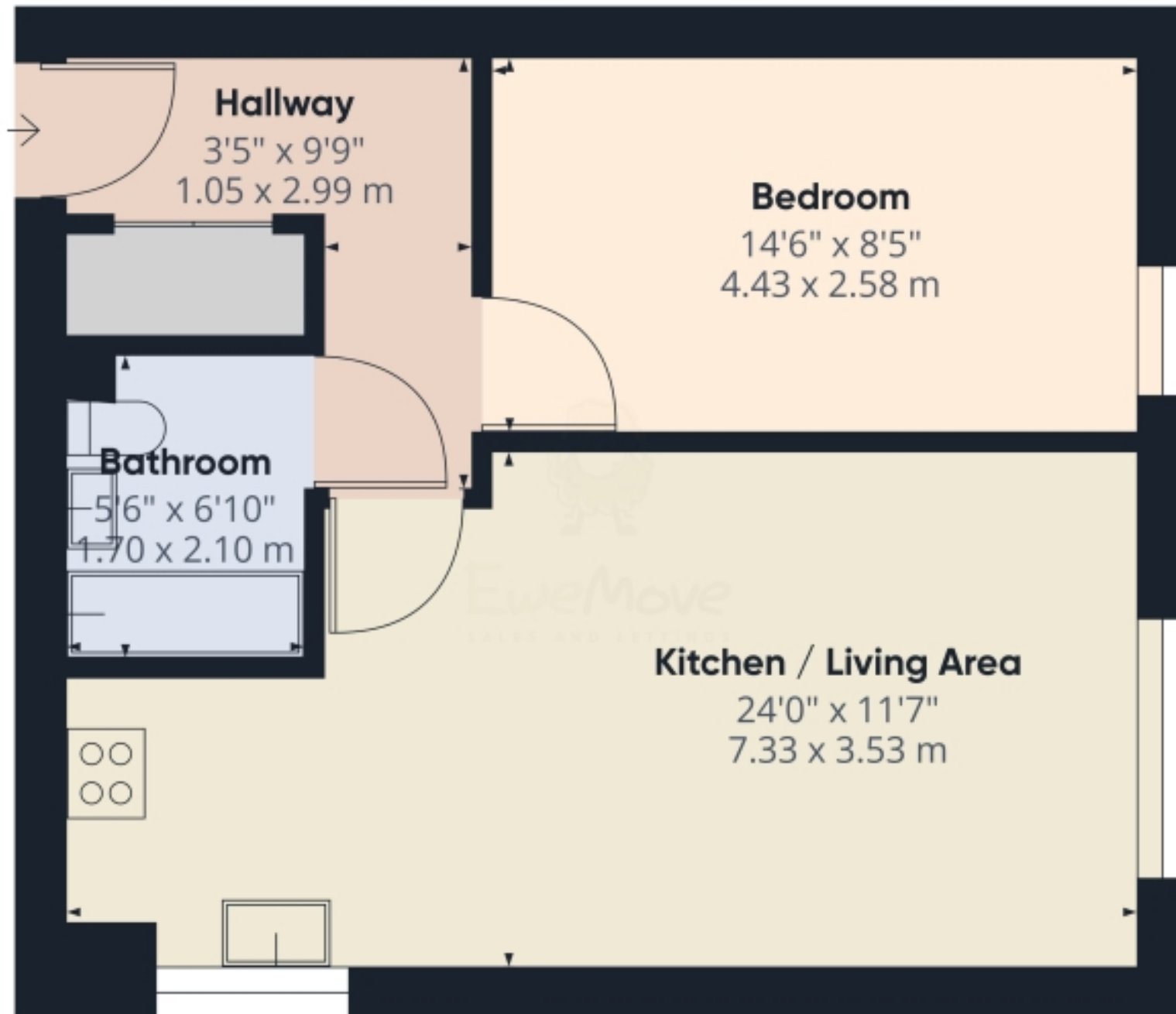

Approximate total area⁽¹⁾

481.09 ft²

44.69 m²

(1) Excluding balconies and terraces

While every attempt has been made to ensure accuracy, all measurements are approximate, not to scale. This floor plan is for illustrative purposes only.

GRAFFE360

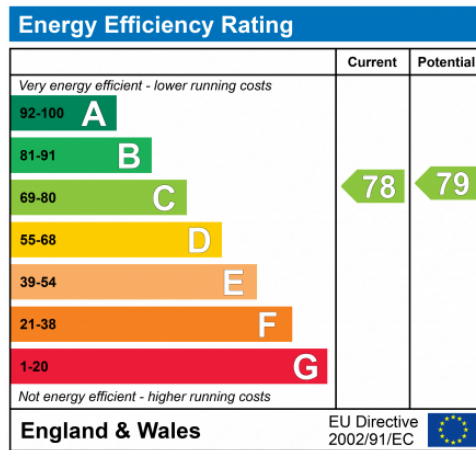



Marketed by Ewemove Dartford & Greenhithe

020 3953 8023 (24/7)
dartford@ewemove.com



EweMove
SALES AND LETTINGS