



Guide Price £450,000

4 Bedroom Not Specified for sale
59 Grosvenor Crescent, Dartford





Overview

Guide Price £450,000 - £4750,000 Introducing a stunning 4 Bedroom extended mid terraced home with it ALL. This home is beautifully decorated, extended modern kitchen, large living room and lounge area, 3 double bedrooms and a single bedroom, driveway for off road parking, great location - within walking distance to Dartford Town Centre and Dartford Station, the list goes on.



Key Features

- Call NOW 24/7 Or Go Online Today To Book
- Driveway For Off Road Parking
- Perfect Location to Dartford Centre and Train Station
- 4 Bedrooms - Master With En Suite
- Beautifully Decorated Throughout
- Large Garden With Rear Access









Guide Price £450,000 - £4750,000 Introducing a stunning 4 Bedroom extended mid terraced home with it ALL. This home is beautifully decorated, extended modern kitchen, large living room and lounge area, 3 double bedrooms and a single bedroom, driveway for off road parking, great location - within walking distance to Dartford Town Centre and Dartford Station, the list goes on.

On entry to this superb home you are met with the porch area, perfect to drop the coats bags and shoes before you enter into this haven of a retreat from every day life. The entrance hall has more room for coats and shoes and entrance to the open plan living dining room, angled bay window to front and wooden floors throughout, this room has space for a large family to be entertained or relaxed and leads seamlessly through to the extended bright kitchen. An over head lantern window allows an abundance of light allowing this room to be super bright and creates a real calming place to cook for the hungry mouths of the family. All within a modern setting complete with integrated appliances, large range style cooker, island with butler sink work surface area and breakfast bar.

The kitchen has french doors opening out to the tiered garden with a space for relaxation, grass area for the kids and the top area which currently houses the hot tub that will stay, a garden shed and rear access, a delightful place to unwind in the sun and all year round.

Up onto the first floor and you are met with carpeted flooring and this floor houses 3 bedrooms and family bathroom, all of these rooms are designed to suit the current owners and in our opinion to a high standard. The two double bedrooms are located to the front and back of the house and have space for large beds, wardrobes and chests of drawers the single bedroom is currently being used as a walk in wardrobe.

The dormer extension on this property was built by Dartfords award winning builder having won "Best General Contractor, Dartford UK" two years in a row so you are sure of an extension that will stand the test of time, the dormer is expansive, bright and incorporates an en suite shower room, eaves storage and a Juliet balcony. There is so much space up here, it has to be seen to understand the size of this gorgeous haven retreat.

In short, this property is everything a growing family needs and represents a property that's easily moved into without any work necessary.

Call today or go online to register your interest today, we have a feeling



Floorplans



Approximate total area
553.25 ft²
51.4 m²

(1) Excluding balconies and terraces

While every attempt has been made to ensure accuracy, all measurements are approximate, not to scale. This floor plan is for illustrative purposes only.

ORAPPE360

Ground Floor

Floorplans



Approximate total area
360.19 ft²
33.46 m²

(1) Excluding balconies and terraces

While every attempt has been made to ensure accuracy, all measurements are approximate, not to scale. This floor plan is for illustrative purposes only.

GRAPPE 360

Floorplans

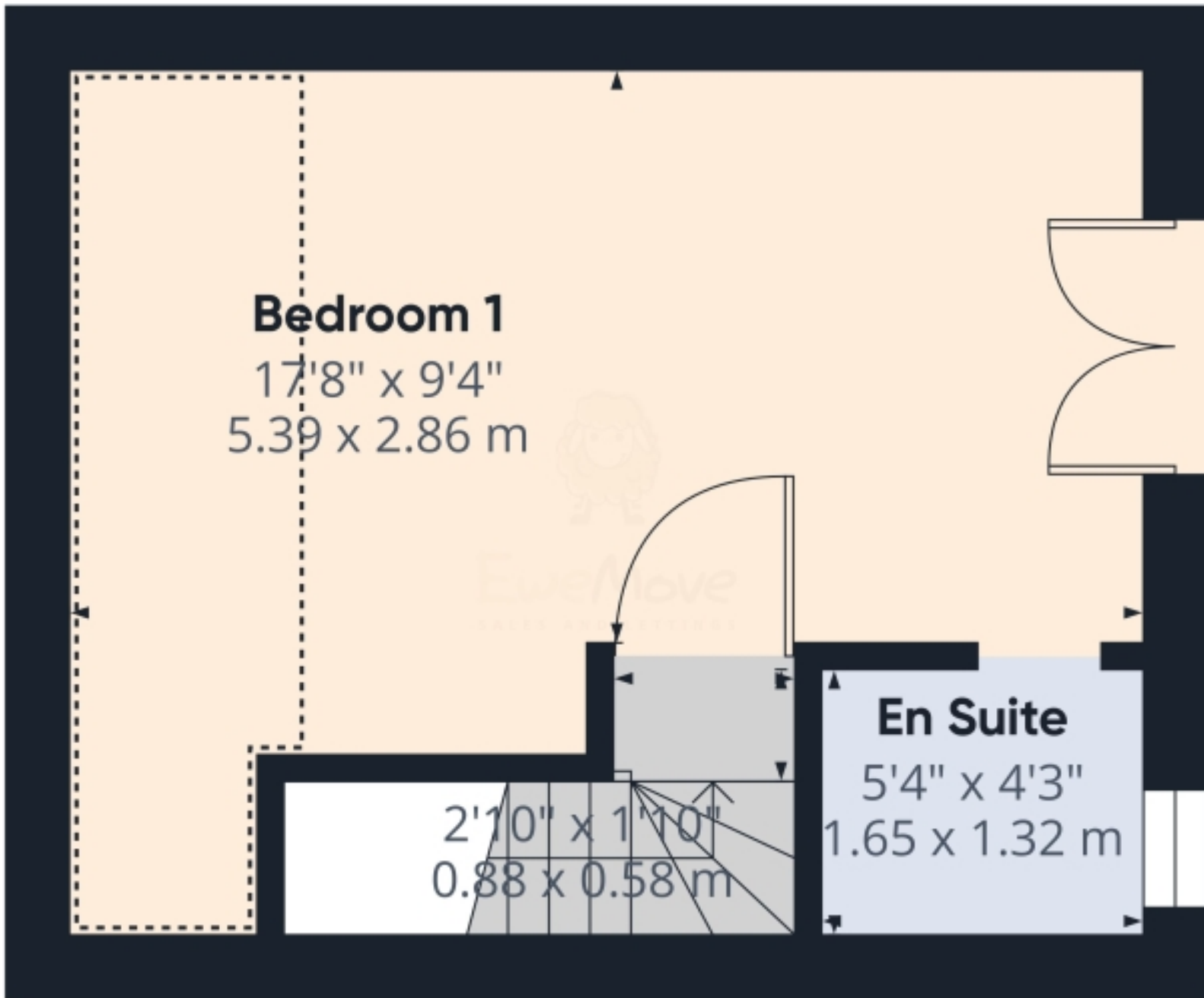

Floor 2



Approximate total area

223.32 ft²
20.75 m²

Reduced headroom

51.62 ft²
4.8 m²

(1) Excluding balconies and terraces

(2) Reduced headroom
(below 1.5m/4.92ft)

While every attempt has been made to ensure accuracy, all measurements are approximate, not to scale. This floor plan is for illustrative purposes only.

GRAFFE 360



Marketed by EweMove Dartford & Greenhithe

020 3953 8023 (24/7)
dartford@ewemove.com

