



£80,000

1 Bedroom Flat for sale

3 St. Stephens Court, Woodville, Swadlincote



EweMove
SALES AND LETTINGS



Overview

Don't miss this one-bedroom, first-floor flat with an incredible lease of 965 years remaining, low annual ground rent of just £100, no service charge, its own private entrance, parking space with extra visitor parking and an allocated garden plot. Located in a quiet, cul-de-sac in a lovely, suburban village close to shops, schools and amenities.



Key Features

- 965 Year Lease
- Low annual fees (£100 ground rent and £185 building insurance)
- Private entrance
- Allocated parking space and extra visitor parking
- Allocated garden plot
- Close to shops, schools and amenities
- No chain
- PIV unit (a low-energy whole home ventilation system)





This one-bedroom self-contained first-floor flat comes with an abundance of features. With a fantastic 965-year lease remaining and low annual fees, it is perfect for investors and first-time buyers. It has its own entrance, garden plot and parking space, as well as extra spaces for any visitors. With a large lounge and double bedroom, with wardrobe space included, this flat has ample space and needs to be seen to appreciate the living space available.

The flat is situated off Moira Road in a quiet, private cul-de-sac. It has a private entrance which leads to the hand-railed staircase. At the top of the stairs is a door which leads into a spacious living area large enough for a sofa, TV and dining table. From the living room are a series of doors. One of which leads to a large double bedroom with built-in wardrobe space. Another leads to the bathroom, which comprises of a bath with an electric shower. Across from the bathroom is a separate kitchen which has plenty of cupboard space and a cooker with an electric hob, separate grill and fan oven. There is also space for a washing machine or dishwasher and for an undercounter fridge/freezer. The flat also has an airing cupboard with shelving and a hot water tank.

The flat has storage heaters in the living room and bedroom along with fan heaters in the kitchen and bathroom, which saves on gas bills. Both the kitchen and bathroom also have extraction fans to remove any moisture and steam and there is a PIV unit fitted in the living room to offer a low-energy home ventilation system.

Outside the flat, there is an allocated parking space and extra visitor parking too. There is also an allocated garden plot and a storage space perfect for lawnmowers and gardening tools, next to the front door. The flat has an incredibly low ground rent of just £100 per annum and a building insurance cost of £185 per annum. It could achieve a rent of £550-£575 PCM.

In accordance with Section 21 of the Estate Agent Act 1979, we declare that there is a personal interest in the sale of this property. The property is being sold by a relative of a member of staff within Potters Sales & Lettings



Floorplans

GROUND FLOOR
407 sq.ft. (37.8 sq.m.) approx.

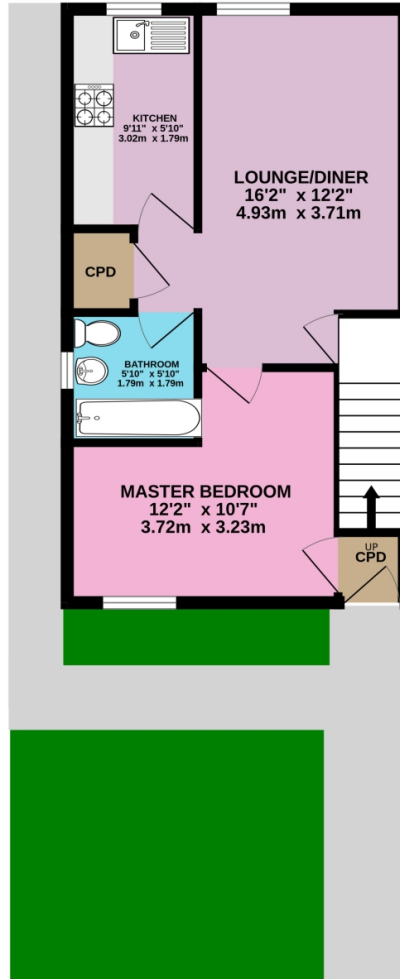

1 BED FIRST FLOOR FLAT

TOTAL FLOOR AREA: 407 sq.ft. (37.8 sq.m.) approx.

Whilst every attempt has been made to ensure the accuracy of the floorplan contained here, measurements of doors, windows, rooms and any other items are approximate and no responsibility is taken for any error, omission or mis-statement. This plan is for illustrative purposes only and should be used as such by any prospective purchaser. The services, systems and appliances shown have not been tested and no guarantee as to their operability or efficiency can be given.
Made with Metropix ©2024

Floorplans

GROUND FLOOR
407 sq.ft. (37.8 sq.m.) approx.

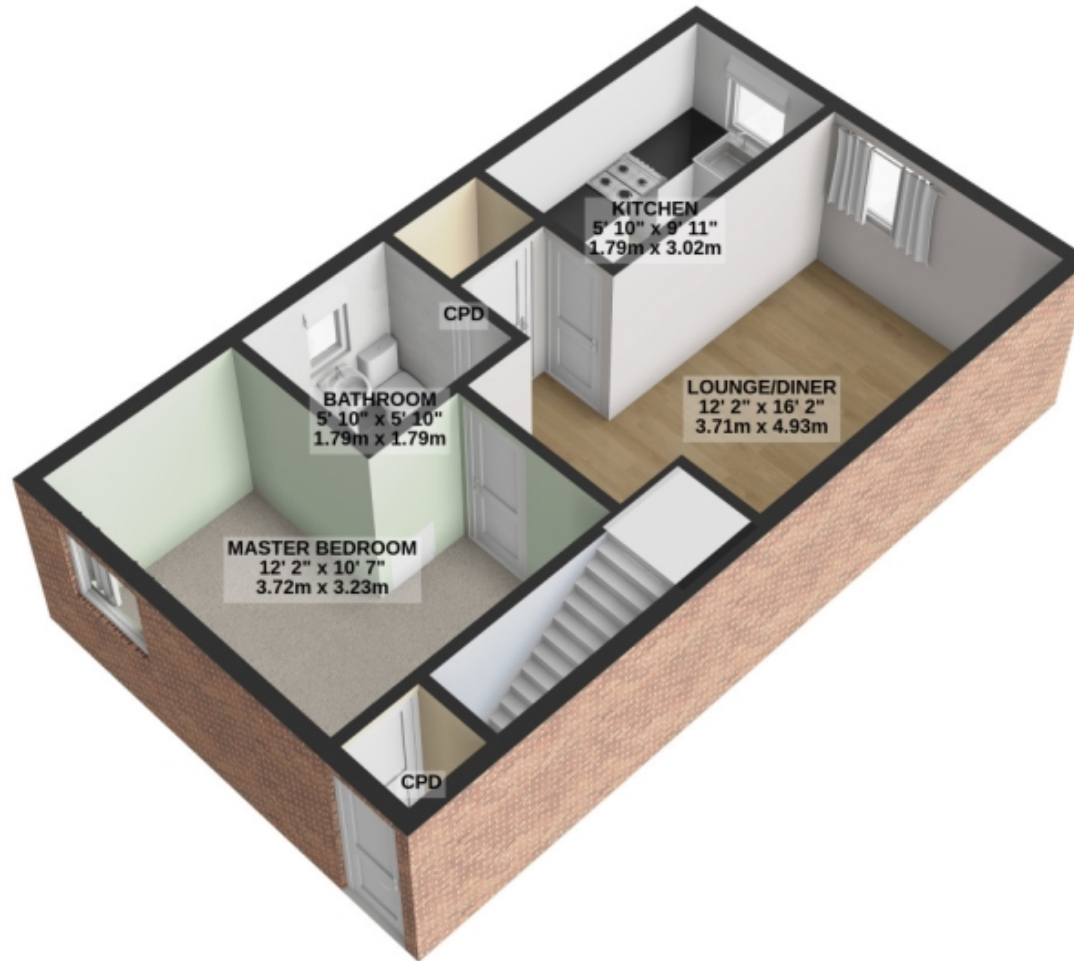

1 BED FIRST FLOOR FLAT
TOTAL FLOOR AREA : 407 sq.ft. (37.8 sq.m.) approx.

For illustrative purposes only. Decorative finishes, fixtures, fittings and furnishings do not represent the current state of the property. Measurements are approximate. Not to scale.

Made with Metropix © 2024

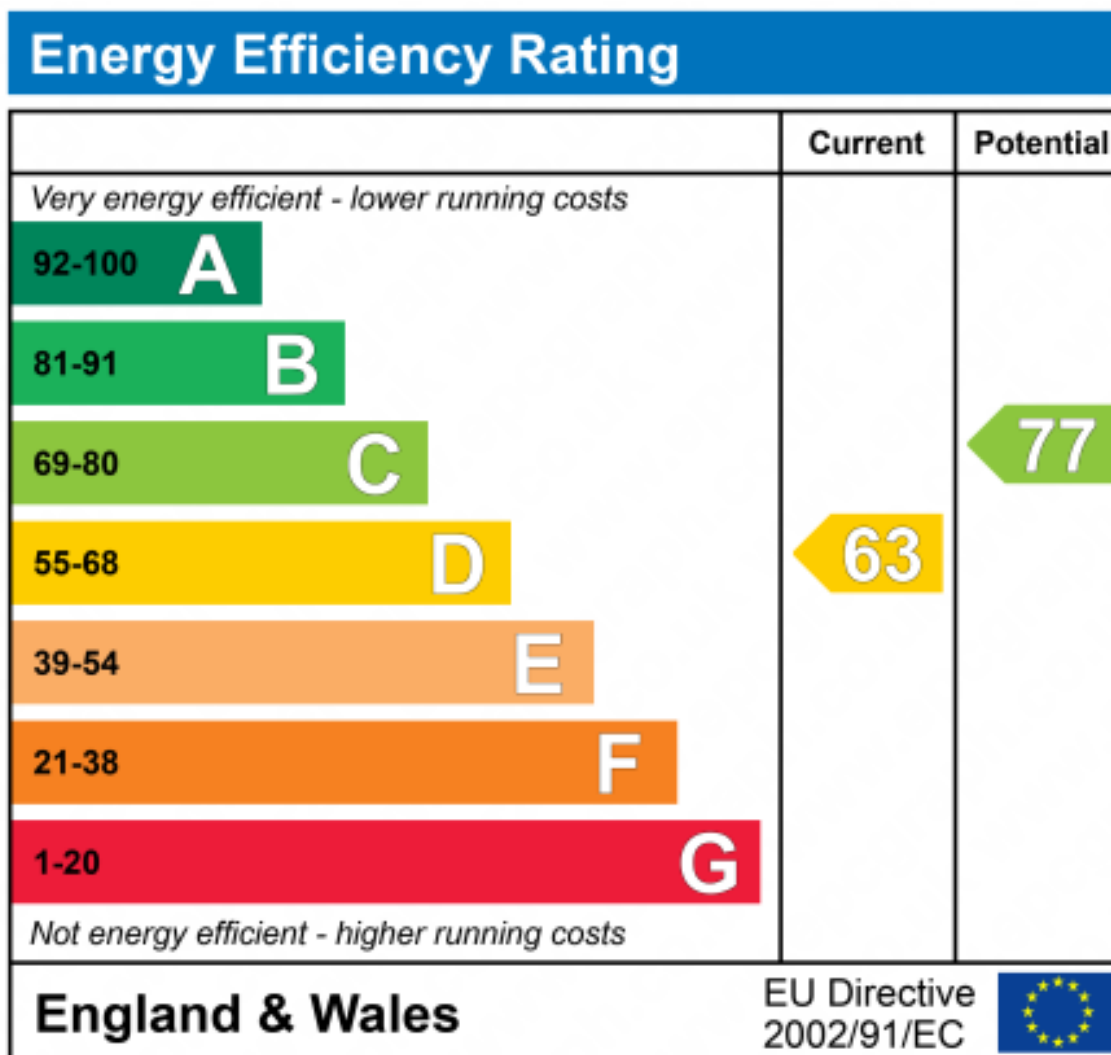

Marketed by EweMove Ashby de la Zouch

01530 442 356 (24/7)

ashbydelazouch@ewemove.com



EweMove
SALES AND LETTINGS